

Southwark London Borough Council



Application for a premises licence to be granted under the Licensing Act 2003

PLEASE READ THE FOLLOWING INSTRUCTIONS FIRST

Before completing this form please read the guidance notes at the end of the form. If you are completing this form by hand please write legibly in block capitals. In all cases ensure that your answers are inside the boxes and written in black ink. Use additional sheets if necessary. You may wish to keep a copy of the completed form for your records.

We Franks Cafe Limited

apply for a premises licence under section 17 of the Licensing Act 2003 for the premises described in Part 1 below (the premises) and I/we are making this application to you as the relevant licensing authority in accordance with section 12 of the Licensing Act 2003

Part 1 – Premises Details

Postal address of premises or, if none, ordnance survey map reference or description			
Frank's Cafe Levels 9 and 10 Peckham Multi-Storey Car Park 95A Rye Lane			
Post town	London	Post code	SE15 4ST

Telephone number at premises (if any)	
Non-domestic rateable value of premises	£41,000

Part 2 - Applicant Details

Please state whether you are applying for a premises licence as
Please tick yes

- a) an individual or individuals * please complete section (A)
- b) a person other than an individual *
 - i. as a limited company please complete section (B)
 - ii. as a partnership please complete section (B)
 - iii. as an unincorporated association or please complete section (B)
 - iv. other (for example a statutory corporation) please complete section (B)
- c) a recognised club please complete section (B)
- d) a charity please complete section (B)
- e) the proprietor of an educational establishment please complete section (B)
- f) a health service body please complete section (B)
- g) a person who is registered under Part 2 of the Care Standards Act 2000 (c14) in respect of an independent hospital please complete section (B)
- ga) a person who is registered under Chapter 2 of Part 1 of the Health and Social Care Act 2008 (within the meaning of that Part) in an independent hospital in England please complete section (B)
- h) the chief officer of police of a police force in England and Wales please complete section (B)

* If you are applying as a person described in (a) or (b) please confirm:

Please tick yes

- I am carrying on or proposing to carry on a business which involves the use of the premises for licensable activities; or
- I am making the application pursuant to a
 - statutory function or
 - a function discharged by virtue of Her Majesty's prerogative

(A) INDIVIDUAL APPLICANTS (fill in as applicable)

Mr <input type="checkbox"/>	Mrs <input type="checkbox"/>	Miss <input type="checkbox"/>	Ms <input type="checkbox"/>	Other Title (for example, Rev)	
Surname			First names		
I am 18 years old or over					<input type="checkbox"/> Please tick yes
Current postal address if different from premises address					
Post Town				Postcode	
Daytime contact telephone number					
E-mail address (optional)					

SECOND INDIVIDUAL APPLICANT (if applicable)

Mr <input type="checkbox"/>	Mrs <input type="checkbox"/>	Miss <input type="checkbox"/>	Ms <input type="checkbox"/>	Other Title (for example, Rev)	
Surname			First names		
I am 18 years old or over					<input type="checkbox"/> Please tick yes
Current postal address if different from premises address					
Post Town				Postcode	
Daytime contact telephone number					
E-mail address (optional)					

(B) OTHER APPLICANTS

Please provide name and registered address of applicant in full. Where appropriate please give any registered number. In the case of a partnership or other joint venture (other than a body corporate), please give the name and address of each party concerned.

Name Franks Cafe Limited
Address 35 Ballards Lane London N3 1XW
Registered number (where applicable) 07276224
Description of applicant (for example, partnership, company, unincorporated association etc.) Limited Company
Telephone number (if any)
E-mail address (optional)

Part 3 Operating Schedule

When do you want the premises licence to start?

Day	Month	Year
A	S	A P

If you wish the licence to be valid only for a limited period, when do you want it to end?

Day	Month	Year

A

Please give a general description of the premises (please read guidance note1) Pop-up bar and restaurant situated on the roof of Peckham Multi-Storey Car Park.
--

If 5,000 or more people are expected to attend the premises at any one time, please state the number expected to attend.

N/A

What licensable activities do you intend to carry on from the premises?

(Please see sections 1 and 14 of the Licensing Act 2003 and Schedules 1 and 2 to the Licensing Act 2003)

Provision of regulated entertainment

Please tick yes

- a) plays (if ticking yes, fill in box A)
- b) films (if ticking yes, fill in box B)
- c) indoor sporting events (if ticking yes, fill in box C)
- d) boxing or wrestling entertainment (if ticking yes, fill in box D)
- e) live music (if ticking yes, fill in box E)
- f) recorded music (if ticking yes, fill in box F)
- g) performances of dance (if ticking yes, fill in box G)

h) anything of a similar description to that falling within (e), (f) or (g) (if ticking yes, fill in box H)

Provision of late night refreshment (if ticking yes, fill in box I)

Supply of alcohol (if ticking yes, fill in box J)

In all cases complete boxes K, L and M

A

Plays Standard days and timings (please read guidance note 6)			Will the performance of a play take place indoors or outdoors or both – please tick (please read guidance note 2)	Indoors	<input checked="" type="checkbox"/>
				Outdoors	<input type="checkbox"/>
				Both	<input type="checkbox"/>
Day	Start	Finish	Please give further details here (please read guidance note 3)		
Mon					
Tue					
Wed			State any seasonal variations for performing plays (please read guidance note 4)		
Thur					
Fri			Non standard timings. Where you intend to use the premises for the performance of plays at different times to those listed in the column on the left, please list (please read guidance note 5)		
Sat					
Sun					

B

Films Standard days and timings (please read guidance note 6)			Will the exhibition of films take place indoors or outdoors or both – please tick (please read guidance note 2)	Indoors	<input checked="" type="checkbox"/>
				Outdoors	<input type="checkbox"/>
				Both	<input type="checkbox"/>
Day	Start	Finish	Please give further details here (please read guidance note 3)		
Mon					
Tue					
Wed			State any seasonal variations for the exhibition of films (please read guidance note 4)		
Thur					
Fri			Non standard timings. Where you intend to use the premises for the exhibition of films at different times to those listed in the column on the left, please list (please read guidance note 5)		
Sat					
Sun					

C

Indoor sporting events Standard days and timings (please read guidance note 6)			Please give further details (please read guidance note 3)
Day	Start	Finish	
Mon			
Tue			
Wed			
Thur			
Fri			
Sat			
Sun			State any seasonal variations for indoor sporting events (please read guidance note 4)
			Non standard timings. Where you intend to use the premises for indoor sporting events at different times to those listed in the column on the left, please list (please read guidance note 5)

D

Boxing or wrestling entertainments Standard days and timings (please read guidance note 6)			Will the boxing or wrestling entertainment take place indoors or outdoors or both – please tick (please read guidance note 2)	
Day	Start	Finish	Indoors	<input checked="" type="checkbox"/>
Mon			Outdoors	<input type="checkbox"/>
Tue			Both	<input type="checkbox"/>
Wed			Please give further details here (please read guidance note 3)	
Thur			State any seasonal variations for boxing or wrestling entertainment (please read guidance note 4)	
Fri			Non standard timings. Where you intend to use the premises for boxing or wrestling entertainment at different times to those listed in the column on the left, please list (please read guidance note 5)	
Sat				
Sun				

E

Live music Standard days and timings (please read guidance note 6)			Will the performance of live music take place indoors or outdoors or both – please tick (please read guidance note 2)	Indoors	<input checked="" type="checkbox"/>
				Outdoors	<input type="checkbox"/>
Day	Start	Finish	Both <input type="checkbox"/>		
Mon			Please give further details here (please read guidance note 3)		
Tue					
Wed			State any seasonal variations for the performance of live music (please read guidance note 4)		
Thur					
Fri			Non standard timings. Where you intend to use the premises for the performance of live music at different times to those listed in the column on the left, please list (please read guidance note 5)		
Sat					
Sun					

F

Recorded music Standard days and timings (please read guidance note 6)			Will the playing of recorded music take place indoors or outdoors or both – please tick (please read guidance note 2)	Indoors	<input type="checkbox"/>
				Outdoors	<input type="checkbox"/>
Day	Start	Finish	Both <input type="checkbox"/>		
Mon			Please give further details here (please read guidance note 3)		
Tue					
Wed			State any seasonal variations for the playing of recorded music (please read guidance note 4)		
Thur					
Fri			Non standard timings. Where you intend to use the premises for the playing of recorded music at different times to those listed in the column on the left, please list (please read guidance note 5)		
Sat					
Sun					

G

Performances of dance Standard days and timings (please read guidance note 6)			Will the performance of dance take place indoors or outdoors or both – please tick (please read guidance note 2)	Indoors	<input checked="" type="checkbox"/>
Day				Outdoors	<input type="checkbox"/>
Start	Finish			Both	<input type="checkbox"/>
Mon				Please give further details here (please read guidance note 3)	
Tue					
Wed			State any seasonal variations for the performance of dance (please read guidance note 4)		
Thur					
Fri			Non standard timings. Where you intend to use the premises for the performance of dance at different times to those listed in the column on the left, please list (please read guidance note 5)		
Sat					
Sun					

H

Anything of a similar description to that falling within (e), (f) or (g) Standard days and timings (please read guidance note 6)			Please give a description of the type of entertainment you will be providing		
Day			Will this entertainment take place indoors or outdoors or both – please tick (please read guidance note 2)	Indoors	<input type="checkbox"/>
Start	Finish	Outdoors		<input type="checkbox"/>	
Mon		Both		<input type="checkbox"/>	
Tue				Please give further details here (please read guidance note 3)	
Wed					
Thur			State any seasonal variations for entertainment of a similar description to that falling within (e), (f) or (g) (please read guidance note 4)		
Fri					
Sat			Non standard timings. Where you intend to use the premises for the entertainment of a similar description to that falling within (e), (f) or (g) at different times to those listed in the column on the left, please list (please read guidance note 5)		
Sun					

I

Late night refreshment Standard days and timings (please read guidance note 6)			Will the provision of late night refreshment take place indoors or outdoors or both – please tick (please read guidance note 2)	Indoors	<input type="checkbox"/>
				Outdoors	<input type="checkbox"/>
				Both	<input type="checkbox"/>
Day	Start	Finish			
Mon			Please give further details here (please read guidance note 3)		
Tue					
Wed			State any seasonal variations for the provision of late night refreshment (please read guidance note 4)		
Thur					
Fri			Non standard timings. Where you intend to use the premises for the provision of late night refreshment at different times, to those listed in the column on the left, please list (please read guidance note 5)		
Sat					
Sun					

J

Supply of alcohol Standard days and timings (please read guidance note 6)			Will the supply of alcohol be for consumption (Please tick box) (please read guidance note 7)	On the premises	<input checked="" type="checkbox"/>
				Off the premises	<input type="checkbox"/>
				Both	<input type="checkbox"/>
Day	Start	Finish			
Mon	11.00	00.00	State any seasonal variations for the supply of alcohol (please read guidance note 4)		
Tue	11.00	00.00			
Wed	11.00	00.00			
Thur	11.00	00.00	Non standard timings. Where you intend to use the premises for the supply of alcohol at different times to those listed in the column on the left, please list (please read guidance note 5)		
Fri	11.00	00.00			
Sat	11.00	00.00			
Sun	11.00	00.00			

State the name and details of the individual whom you wish to specify on the licence as premises supervisor

Name Not yet known

Address Not yet known	
Postcode	
Personal Licence number (if known)	
Issuing licensing authority (if known)	

K

<p>Please highlight any adult entertainment or services, activities, other entertainment or matters ancillary to the use of the premises that may give rise to concern in respect of children (please read guidance note 8)</p> <p>None</p>
--

L

Hours premises are open to the public Standard days and timings (please read guidance note 6)			State any seasonal variations (please read guidance note 4)
Day	Start	Finish	
Mon	11.00	00.30	
Tue	11.00	00.30	
Wed	11.00	00.30	
Thur	11.00	00.30	
Fri	11.00	00.30	
Sat	11.00	00.30	
Sun	11.00	00.30	
			Non standard timings. Where you intend the premises to be open to the public at different times from those listed in the column on the left, please list (please read guidance note 5)

M Describe the steps you intend to take to promote the four licensing objectives:

a) General – all four licensing objectives (b,c,d,e) (please read guidance note 9)

<p>This is an application for Levels 9 and 10 of Peckham Multi-Storey Car Park.</p> <p>The Responsible Authorities will be familiar with Frank's Café which has been licensed on a time limited basis over the last 6 years.</p> <p>This application is similar to those but is not time limited and is only for floors 9 and 10 (as opposed to 7-10). The intention is to operate these floors both as Frank's Café and as a space which will be regularly used by the Arts Organisation (a local arts company) to hold various exhibitions.</p>

The applicant also seeks to simplify the number of conditions which were imposed on Premises Licence 844411 which are either irrelevant because they refer to other floors or relate to entertainment activities not included or are covered by new amended conditions.

The applicant has through Frank Boxer established good local relationships and hopes that the grant of the licence will be of benefit culturally to the area. It is mindful that the premises are in the cumulative impact area but bearing in mind the nature of the premises and its previous trading history it does not consider it will add to the impact.

b) The prevention of crime and disorder

See box c), d) and e)

c) Public safety

1. The Premises Licence Holder will obtain an expert's report in relation to both health & safety and fire safety issues and a copy of this report will be sent to the Responsible Authorities prior to commencement of trading and the premises will operate in accordance with these reports whenever they are open to conduct licensable activities.
2. A capacity limit of 1000 persons shall not be exceeded at any time and will be controlled by use of clickers
3. No open containers of alcohol or any other drink shall be taken outside of the premises.
4. Dedicated members of staff shall ensure that empty or unused drink containers and other materials are now allowed to accumulate on or around the perimeter wall.
5. All suspended equipment e.g. roof canopy shall be examined by a competent person to ensure their structural integrity and a record of this inspection made. Adequate controls and fixtures should be in place to prevent the risk of suspended equipment falling.
6. All parts of the premises shall be provided with adequate illumination.

d) The prevention of public nuisance

1. A risk assessment will be prepared in relation to the need for SIA door staff including time and number but in any event whenever the premises is open for licensable activities a minimum of four SIA door staff will be on duty from 6pm on Sunday to Thursday until all members of the public have left the premises and a minimum of five from 6pm on Friday and Saturday but rising to eight from 8pm until all members of the public have left the premises.
2. A crowd dispersal strategy shall be implemented to assist with patrons leaving the premises in an orderly and safe manner.
3. Volume control for "background" recorded music shall be stationed behind the bar, and under the sole control of the manager on duty.
4. A dedicated telephone number shall be provided for local residents to contact the site manager whilst the premises is in operation.

ae) The protection of children from harm

1. The premises shall operate the "Challenge 25" age identification scheme including full staff training and appropriate signage.

Please tick yes

- I have made or enclosed payment of the fee or
- I have not made or enclosed payment of the fee because the application has been made in relation to the introduction of the late night levy
- I have enclosed the plan of the premises
- I have sent copies of this application and the plan to responsible authorities and others where applicable
- I have enclosed the consent form completed by the individual I wish to be designated premises supervisor, if applicable
- I understand that I must now advertise my application
- I understand that if I do not comply with the above requirements my application will be rejected

IT IS AN OFFENCE, LIABLE ON CONVICTION TO A FINE UP TO LEVEL 5 ON THE STANDARD SCALE, UNDER SECTION 158 OF THE LICENSING ACT 2003 TO MAKE A FALSE STATEMENT IN OR IN CONNECTION WITH THIS APPLICATION

Part 4 – Signatures (please read guidance note 10)

Signature of applicant or applicant's solicitor or other duly authorised agent (See guidance note 11). **If signing on behalf of the applicant please state in what capacity.**

Signature	
Date	01 April 2015
Capacity	Poppleston Allen – Solicitors for and on behalf of the applicant

For joint applications signature of 2nd applicant or 2nd applicant's solicitor or other authorised agent. (please read guidance note 12). **If signing on behalf of the applicant please state in what capacity.**

Signature	
Date	
Capacity	

Contact name (where not previously given) and postal address for correspondence associated with this application (please read guidance note 13)

Vicki Caress
Popleston Allen Solicitors
37 Stoney Street
The Lace Market

Post town	Nottingham	Post code	NG1 1LS
------------------	------------	------------------	---------

Telephone number (if any)	0115 934 9176
----------------------------------	---------------

If you would prefer us to correspond with you by e-mail your e-mail address (optional)

v.caress@popall.co.uk

Notes for Guidance

1. Describe the premises. For example the type of premises, its general situation and layout and any other information which could be relevant to the licensing objectives. Where your application includes off-supplies of alcohol and you intend to provide a place for consumption of these off-supplies you must include a description of where the place will be and its proximity to the premises.
2. Where taking place in a building or other structure please tick as appropriate. Indoors may include a tent.
3. For example the type of activity to be authorised, if not already stated, and give relevant further details, for example (but not exclusively) whether or not music will be amplified or unamplified.
4. For example (but not exclusively), where the activity will occur on additional days during the summer months.
5. For example (but not exclusively), where you wish the activity to go on longer on a particular day e.g. Christmas Eve.
6. Please give timings in 24 hour clock (e.g. 16:00) and only give details for the days of the week when you intend the premises to be used for the activity.
7. If you wish people to be able to consume alcohol on the premises please tick on, if you wish people to be able to purchase alcohol to consume away from the premises please tick off. If you wish people to be able to do both please tick both.
8. Please give information about anything intended to occur at the premises or ancillary to the use of the premises which may give rise to concern in respect of children, regardless of whether you intend children to have access to the premises, for example (but not exclusively) nudity or semi-nudity, films for restricted age groups, the presence of gaming machines.
9. Please list here steps you will take to promote all four licensing objectives together.
10. The application form must be signed.
11. An applicant's agent (for example solicitor) may sign the form on their behalf provided that they have actual authority to do so.
12. Where there is more than one applicant, both applicants or their respective agents must sign the application form.
13. This is the address which we shall use to correspond with you about this application.

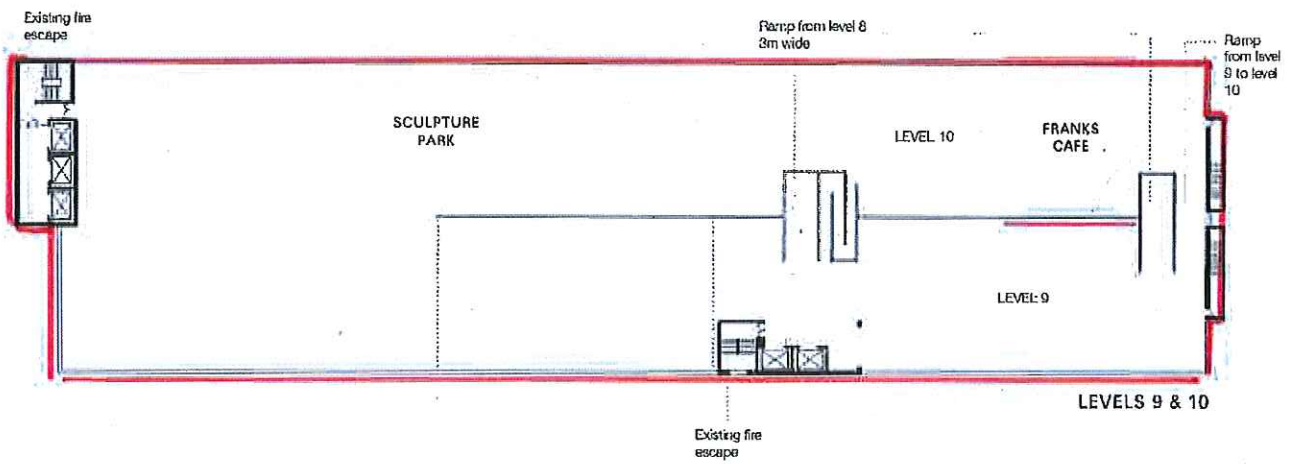

Plan Number 01

— = Area for licensable activities.