

01/04/2022

Business - Application for a premises licence to be granted under the Licensing Act 2003

Ref No. 1823893

Name of Applicant

Please enter the name(s) who is applying for a premises licence under section 17 of the Licensing Act 2003 and am making this application to you as the relevant licensing authority in accordance with section 12 of the Licensing Act 2003

Ad Hoc Pubs Limited
---------------------

Notes for Guidance

1. Describe the premises, for example the type of premises, its general situation and layout and any other information which could be relevant to the licensing objectives. Where your application includes off-supplies of alcohol and you intend to provide a place for consumption of these off-supplies, you must include a description of where the place will be and its proximity to the premises.
2. In terms of specific regulated entertainments please note that:
  - Plays: no licence is required for performances between 08:00 and 23.00 on any day, provided that the audience does not exceed 500.
  - Films: no licence is required for 'not-for-profit' film exhibition held in community premises between 08.00 and 23.00 on any day provided that the audience does not exceed 500 and the organiser (a) gets consent to the screening from a person who is responsible for the premises; and (b) ensures that each such screening abides by age classification ratings.
  - Indoor sporting events: no licence is required for performances between 08.00 and 23.00 on any day, provided that the audience does not exceed 1000.
  - Boxing or Wrestling Entertainment: no licence is required for a contest, exhibition or display of Greco-Roman wrestling, or freestyle wrestling between 08.00 and 23.00 on any day, provided that the audience does not exceed 1000. Combined fighting sports – defined as a contest, exhibition or display which combines boxing or wrestling with one or more martial arts – are licensable as a boxing or wrestling entertainment rather than an indoor sporting event.
  - Live music: no licence permission is required for:
    - o a performance of unamplified live music between 08.00 and 23.00 on any day, on any premises.
    - o a performance of amplified live music between 08.00 and 23.00 on any day on premises authorised to sell alcohol for consumption on those premises, provided that the audience does not exceed 500.
    - o a performance of amplified live music between 08.00 and 23.00 on any day, in a workplace that is not licensed to sell alcohol on those premises, provided that the audience does not exceed 500.
    - o a performance of amplified live music between 08.00 and 23.00 on any day, in a church hall, village hall, community hall, or other similar community premises, that is not licensed by a premises licence to sell alcohol, provided that (a) the audience does not exceed 500, and (b) the organiser gets consent for the performance from a person who is responsible for the premises.
    - o a performance of amplified live music between 08.00 and 23.00 on any day, at the non-residential premises of (i) a local authority, or (ii) a school, or (iii) a hospital, provided that (a) the audience does not exceed 500, and (b) the organiser gets consent for the performance on the relevant premises from: (i) the local authority concerned, or (ii) the school or (iii) the health care provider for the hospital.
  - Recorded Music: no licence permission is required for:
    - o any playing of recorded music between 08.00 and 23.00 on any day on premises authorised to sell alcohol for consumption on those premises, provided that the audience does not exceed 500.
    - o any playing of recorded music between 08.00 and 23.00 on any day, in a church hall, village hall, community hall, or other similar community premises, that is not licensed by a premises licence to sell alcohol, provided that (a) the audience does not exceed 500, and (b) the organiser gets consent for the performance from a person who is responsible for the premises.
    - o any playing of recorded music between 08.00 and 23.00 on any day, at the non-residential premises of (i) a local authority, or (ii) a school, or (iii) a hospital, provided that (a) the audience does not exceed 500, and (b) the organiser gets consent for the performance on the relevant premises from: (i) the local authority concerned, or (ii) the school proprietor or (iii) the health care provider for the hospital.
  - Dance: no licence is required for performances between 08.00 and 23.00 on any day, provided that the audience does not exceed 500. However, a performance which amounts to adult entertainment remains licensable.
  - Cross activity exemptions: no licence is required between 08.00 and 23.00 on any day, with no limit on audience size for:
    - o any entertainment taking place on the premises of the local authority where the entertainment is provided by or on behalf of the local authority;
    - o any entertainment taking place on the hospital premises of the health care provider where the

entertainment is provided by or on behalf of the health care provider;

o any entertainment taking place on the premises of the school where the entertainment is provided by or on behalf of the school proprietor; and

o any entertainment (excluding films and a boxing or wrestling entertainment) taking place at a travelling circus, provided that (a) it takes place within a moveable structure that accommodates the audience, and (b) that the travelling circus has not been located on the same site for more than 28 consecutive days.

3. Where taking place in a building or other structure please tick as appropriate (indoors may include a tent).

4. For example the type of activity to be authorised, if not already stated, and give relevant further details, for example (but not exclusively) whether or not music will be amplified or unamplified.

5. For example (but not exclusively), where the activity will occur on additional days during the summer months.

6. For example (but not exclusively), where you wish the activity to go on longer on a particular day e.g. Christmas Eve.

7. Please give timings in 24 hour clock (e.g. 16.00) and only give details for the days of the week when you intend the premises to be used for the activity.

8. If you wish people to be able to consume alcohol on the premises, please tick 'on the premises'. If you wish people to be able to purchase alcohol to consume away from the premises, please tick 'off the premises'. If you wish people to be able to do both, please tick 'both'.

9. Please give information about anything intended to occur at the premises or ancillary to the use of the premises which may give rise to concern in respect of children, regardless of whether you intend children to have access to the premises, for example (but not exclusively) nudity or semi-nudity, films for restricted age groups or the presence of gaming machines.

10. Please list here steps you will take to promote all four licensing objectives together.

11. The application form must be signed.

12. An applicant's agent (for example solicitor) may sign the form on their behalf provided that they have actual authority to do so.

13. Where there is more than one applicant, each of the applicants or their respective agent must sign the application form.

14. This is the address which we shall use to correspond with you about this application.

15. Entitlement to work/immigration status for individual applicants and applications

from partnerships which are not limited liability partnerships:

A licence may not be held by an individual or an individual in a partnership who is resident in the UK who:

- does not have the right to live and work in the UK; or
- is subject to a condition preventing him or her from doing work relating to the carrying on of a licensable activity.

Any premises licence issued in respect of an application made on or after 6 April 2017 will become invalid if the holder ceases to be entitled to work in the UK.

Applicants must demonstrate that they have an entitlement to work in the UK and are not subject to a condition preventing them from doing work relating to the carrying on of a licensable activity. They do this in one of two ways: 1) by providing with this application copies or scanned copies of the documents listed below (which do not need to be certified), or 2) by providing their 'share code' to enable the licensing authority to carry out a check using the Home Office online right to work checking service (see below).

Documents which demonstrate entitlement to work in the UK

- An expired or current passport showing the holder, or a person named in the passport as the child of the holder, is a British citizen or a citizen of the UK and Colonies having the right of abode in the UK [please see note below about which sections of the passport to copy].
- An expired or current passport or national identity card showing the holder, or a person named in the passport as the child of the holder, is a national of a European Economic Area country or Switzerland.
- A Registration Certificate or document certifying permanent residence issued by the Home Office to a national of a European Economic Area country or Switzerland.
- A Permanent Residence Card issued by the Home Office to the family member of a national of a European Economic Area country or Switzerland.
- A current Biometric Immigration Document (Biometric Residence Permit) issued by the Home Office to the holder indicating that the person named is allowed to stay indefinitely in the UK, or has no time limit on their stay in the UK.
- A current passport endorsed to show that the holder is exempt from immigration control, is allowed to stay indefinitely in the UK, has the right of abode in the UK, or has no time limit on their stay in the UK.

- A current Immigration Status Document issued by the Home Office to the holder with an endorsement indicating that the named person is allowed to stay indefinitely in the UK or has no time limit on their stay in the UK, when produced in combination with an official document giving the person's permanent National Insurance number and their name issued by a Government agency or a previous employer.
- A birth or adoption certificate issued in the UK, when produced in combination with an official document giving the person's permanent National Insurance number and their name issued by a Government agency or a previous employer.
- A birth or adoption certificate issued in the Channel Islands, the Isle of Man or Ireland when produced in combination with an official document giving the person's permanent National Insurance number and their name issued by a Government agency or a previous employer.
- A certificate of registration or naturalisation as a British citizen, when produced in combination with an official document giving the person's permanent National Insurance number and their name issued by a Government agency or a previous employer.
- A current passport endorsed to show that the holder is allowed to stay in the UK and is currently allowed to work and is not subject to a condition preventing the holder from doing work relating to the carrying on of a licensable activity.
- A current Biometric Immigration Document (Biometric Residence Permit) issued by the Home Office to the holder which indicates that the named person can currently stay in the UK and is allowed to work relation to the carrying on of a licensable activity.
- A current Residence Card issued by the Home Office to a person who is not a national of a European Economic Area state or Switzerland but who is a family member of such a national or who has derivative rights or residence.
- A current Immigration Status Document containing a photograph issued by the Home Office to the holder with an endorsement indicating that the named person may stay in the UK, and is allowed to work and is not subject to a condition preventing the holder from doing work relating to the carrying on of a licensable activity when produced in combination with an official document giving the person's permanent National Insurance number and their name issued by a Government agency or a previous employer.
- A Certificate of Application, less than 6 months old, issued by the Home Office under regulation 18(3) or 20(2) of the Immigration (European Economic Area) Regulations 2016, to a person who is not a national of a

European Economic Area state or Switzerland but who is a family member of such a national or who has derivative rights of residence.

- Reasonable evidence that the person has an outstanding application to vary their permission to be in the UK with the Home Office such as the Home Office acknowledgement letter or proof of postage evidence, or reasonable evidence that the person has an appeal or administrative review pending on an immigration decision, such as an appeal or administrative review reference number.
  
- Reasonable evidence that a person who is not a national of a European Economic Area state or Switzerland but who is a family member of such a national or who has derivative rights of residence in exercising treaty rights in the UK including:
  - o evidence of the applicant's own identity – such as a passport,
  
  - o evidence of their relationship with the European Economic Area family member – e.g. a marriage certificate, civil partnership certificate or birth certificate, and
  
  - o evidence that the European Economic Area national has a right of permanent residence in the UK or is one of the following if they have been in the UK for more than 3 months:
    - (i) working e.g. employment contract, wage slips, letter from the employer,
  
    - (ii) self-employed e.g. contracts, invoices, or audited accounts with a bank,
  
    - (iii) studying e.g. letter from the school, college or university and evidence of sufficient funds; or
  
    - (iv) self-sufficient e.g. bank statements.

Family members of European Economic Area nationals who are studying or financially independent must also provide evidence that the European Economic Area national and any family members hold comprehensive sickness insurance in the UK. This can include a private medical insurance policy, an EHIC card or an S1, S2 or S3 form.

Original documents must not be sent to licensing authorities. If the document copied is a passport, a copy of the following pages should be provided:

- (i) any page containing the holder's personal details including nationality;
  
- (ii) any page containing the holder's photograph;
  
- (iii) any page containing the holder's signature;

(iv) any page containing the date of expiry; and

(v) any page containing information indicating the holder has permission to enter or remain in

the UK and is permitted to work.

If the document is not a passport, a copy of the whole document should be provided.

Your right to work will be checked as part of your licensing application and this could involve us checking your immigration status with the Home Office. We may otherwise share information with the Home Office. Your licence application will not be determined until you have complied with this guidance.

#### Home Office online right to work checking service

As an alternative to providing a copy of the documents listed above, applicants may demonstrate their right to work by allowing the licensing authority to carry out a check with the Home Office online right to work checking service.

To demonstrate their right to work via the Home Office online right to work checking service, applicants should include in this application their 9-digit share code (provided to them upon accessing the service at <https://www.gov.uk/prove-right-to-work>) which, along with the applicant's date of birth (provided within this application), will allow the licensing authority to carry out the check.

In order to establish the applicant's right to work, the check will need to indicate that the applicant is allowed to work in the United Kingdom and is not subject to a condition preventing them from doing work relating to the carrying on of a licensable activity.

An online check will not be possible in all circumstances because not all applicants will have an immigration status that can be checked online. The Home Office online right to work checking service sets out what information and/or documentation applicants will need in order to access the service. Applicants who are unable to obtain a share code from the service should submit copy documents as set out above.

#### Premises Details

Application for a premises licence to be granted under the Licensing Act 2003

Non-domestic rateable value of premises in order to see your rateable value [click here](#) (opens in new window)

£	37750
	Band D and E only applies to premises which uses exclusively or primarily for the supply of alcohol for consumption on the premises

#### Premises trading name

	Southwark Tap and Wine Bar
--	----------------------------

Postal address of premises or, if none, ordnance survey map reference or description

Do you have a Southwark postcode?	Yes
Address Line 1	Railway Arch 80
Address Line 2	Scoresby Street
Town	London
Post code	SE1 0XN
Ordnance survey map reference	
Description of the location	
Telephone number	

Applicant Details

Please select whether you are applying for a premises licence as

	a person other than an individual (limited company, partnership etc)
--	--

If you are applying as an individual or non-individual please select one of the following:-

	I am carrying on or proposing to carry on a business which involves the use of the  premises for licensable activities
--	---

Other Applicants

Please provide name and registered address of applicant in full. Where appropriate please give any registered number. In the case of a partnership or other joint venture (other than a body corporate), please give the name and address of each party concerned.

Name - First Entry

	Ad Hoc Pubs Limited
--	---------------------

Address - First Entry

Street number or building name	128
Street Description	Clapham Manor Street
Town	London
County	
Post code	sw4 6ed
Registered number ( where applicable )	13626330

Description of applicant ( for example, partnership, company, unincorporated association etc )	Limited Company
--	-----------------

Contact Details - First Entry

Telephone number	
Email address	clapham.tap@gmail.com

Operating Schedule

When do you want the premises licence to start?

	01/05/2022
--	------------

If you wish the licence to be valid only for a limited period, when do you want it to end?

--	--

General description of premises ( see guidance note 1 )

	premises are a converted railway arch, consists of ground floor and mezzanine area. premises will consist of restaurant and wine bar with provision of live and recorded music. provision and consumption of alcohol on the premises. Premises are enclosed with no beer garden, except a small frontage areas for smoking (max. 10 people). Premises were previously occupied as licensed premises - Blackfriars wine bar. current premises will be similar layout with adult professional clientele. Only structural difference will is the mezzanine. Maximum capacity of 120 people.
--	--

If 5,000 or more people are expected to attend the premises at any one time please use the drop down below to select the number.

	Less than 5000
--	----------------

Note 1

Describe the premises. For example the type of premises, its general situation and layout and any other information which could be relevant to the licensing objectives. Where your application includes off-supplies of alcohol and you intend to provide a place of consumption of these off-supplies of alcohol, you must include a description of where the place will be and its proximity to the premises.

Operating Schedule part 2

What licensable activities do you intend to carry on from the premises?



	(Please see sections 1 and 14 of the Licensing Act 2003 and schedule 1 and 2 of the Licensing Act 2003)
--	---

Provision of regulated entertainment (Please read guidance note 2)

	e) live music
	f) recorded music

Provision of late night refreshment

	i) Late night refreshment
--	---------------------------

Supply of alcohol

	j) Supply of alcohol
--	----------------------

In all cases please complete boxes K, L and M.

E - Live Music

Will the performance of live music take place indoors or outdoors or both? ( Please read guidance note 3)

	Indoors
--	---------

Please give further details here ( Please read guidance note 4)

	Back ground music. person on a piano/ keyboard. Indoors only, Will be finished by 2230hrs.
--	--

Standard days and timings for Live Music ( Please read guidance note 7)

Day	Start	Finish
Mon	18:00	22:30
Tues	18:00	22:30
Wed	18:00	22:30
Thur	18:00	22:30
Fri	18:00	22:30

Sat	18:00	22:30
Sun	18:00	22:30

State any seasonal variations for the performance of live music ( Please read guidance note 5 )

	none
--	------

Non standard timings. Where you intend to use the premises for the performance of live music at different times to those listed. ( Please read guidance note 6 )

	none
--	------

3. Where taking place in a building or other structure please tick as appropriate (indoors may include a tent).
4. For example the type of activity to be authorised, if not already stated, and give relevant further details.
5. For example (but not exclusively), where the activity will occur on additional days during the summer months.
6. For example (but not exclusively), where you wish the activity to go on longer on a particular day e.g. Christmas Eve.
7. Please give timings in 24 hour clock (e.g. 16.00) and only give details for the days of the week when you intend the premises to be used for the activity.

F - Recorded Music

Will the playing of recorded music take place indoors or outdoors or both? ( Please read guidance note 3 )

	Indoors
--	---------

Please give further details here ( Please read guidance note 4)

	background music only
--	-----------------------

Standard days and timings for Recorded Music ( Please read guidance note 7 )

Day	Start	Finish
Mon	11:00	22:30
Tues	11:00	22:30
Wed	11:00	22:30
Thur	11:00	22:30
Fri	11:00	22:30
Sat	11:00	22:30
Sun	11:00	22:30

State any seasonal variations for playing recorded music ( Please read guidance note 5)

	none
--	------

Non standard timings. Where you intend to use the premises for the playing of recorded music entertainment at different times to those listed. ( Please read guidance note 6 )

	none
--	------

3. Where taking place in a building or other structure please tick as appropriate (indoors may include a tent).
4. For example the type of activity to be authorised, if not already stated, and give relevant further details, for example (but not exclusively) whether or not music will be amplified or unamplified.
5. For example (but not exclusively), where the activity will occur on additional days during the summer months.
6. For example (but not exclusively), where you wish the activity to go on longer on a particular day e.g. Christmas Eve.
7. Please give timings in 24 hour clock (e.g. 16.00) and only give details for the days of the week when you intend the premises to be used for the activity.

I - Late Night Refreshment

Will the provision of late night refreshment take place indoors or outdoors or both? ( Please read guidance note 3 )

	Indoors
--	---------

Please give further details here ( Please read guidance note 4 )

	terminal hour Thursdays - Saturdays will be 00:30 therefore allow for customers to finish meals etc. up to midnight on those nights.
--	--

Standard days & timings for Late night refreshment (Late night start time is from 23.00, see guidance notes 7)

Day	Start	Finish
Mon		
Tues		
Wed		
Thur	23:00	00:00
Fri	23:00	00:00
Sat	23:00	00:00
Sun		

State any seasonal variations for the provision of late night refreshment ( Please read guidance note 5 )

	none
--	------

Non standard timings. Where you intend to use the premises for the provision of late night refreshment at different times, to those listed. Please list, ( Please read guidance note 6 )

	none
--	------

3. Where taking place in a building or other structure please tick as appropriate (indoors may include a tent).
4. For example the type of activity to be authorised, if not already stated, and give relevant further details, for example (but not exclusively) whether or not music will be amplified or unamplified.
5. For example (but not exclusively), where the activity will occur on additional days during the summer months.
6. For example (but not exclusively), where you wish the activity to go on longer on a particular day e.g. Christmas Eve.
7. Please give timings in 24 hour clock (e.g. 23:00) and only give details for the days of the week when you intend the premises to be used for the activity. Start time begins from 23:00

J - Supply of Alcohol

Will the supply of alcohol be for consumption ( Please read guidance note 8)

	On the premises
--	-----------------

Standard days and timings for Supply of alcohol ( Please read guidance note 7)

Day	Start	Finish
Mon	11:00	23:00
Tues	11:00	23:00
Wed	11:00	23:00
Thur	11:00	00:00
Fri	11:00	00:00
Sat	11:00	00:00
Sun	11:00	23:00

State any seasonal variations for the supply of alcohol ( Please read guidance 5)

	none
--	------

Non standard timings. Where you intend to use the premises for the supply of alcohol at different times to those listed. Please list, ( Please read guidance note 6 )

	none
--	------

Please download and then upload the consent form completed by the designated proposed premises supervisor

--	--

5. For example (but not exclusively), where the activity will occur on additional days during the summer months.
6. For example (but not exclusively), where you wish the activity to go on longer on a particular day e.g. Christmas Eve.
7. Please give timings in 24 hour clock (e.g. 16:00) and only give details for the days of the week when you intend the premises to be used for the activity.
8. If you wish people to be able to consume alcohol on the premises, please tick 'on the premises'. If you wish people to be able to purchase alcohol to consume away from the premises, please tick 'off the premises'. If you wish people to be able to do both, please tick 'both'.

Premises Supervisor

State the name and details of the individual whom you wish to specify on the licence as the designated premises supervisor (Please see declaration about the entitlement to work in the check list at the end of the form)

Full name of proposed designated premises supervisor

First names	Tristan Timothy
Surname	Angel

DOB

Date Of Birth	
---------------	--

Address of proposed designated premises supervisor

Street number or Building name	
Street Description	
Town	
County	
Post code	

Personal licence number of proposed designated premises supervisor, if any,

Personal licence number ( if known )	
Issuing authority ( if known )	Lambeth Council

K

Please highlight any adult entertainment or services, activities, other entertainment or matters ancillary to the use of the premises that may give rise to concern in respect of children ( Please read guidance note 9)

	None
--	------

9. Please give information about anything intended to occur at the premises or ancillary to the use of the premises which may give rise to concern in respect of children, regardless of whether you intend children to have access to the premises, for example (but not exclusively) nudity or semi-nudity, films for restricted age groups or the presence of gaming machines.

L - Hours premises are open to public

5. For example (but not exclusively), where the activity will occur on additional days during the summer months.

6. For example (but not exclusively), where you wish the activity to go on longer on a particular day e.g. Christmas Eve.

7. Please give timings in 24 hour clock (e.g. 16:00) and only give details for the days of the week when you intend the premises to be used for the activity.

Hours premises are open to the public ( standard timings Please read guidance note 7 )

Day	Start	Finish
Mon	11:00	23:30
Tues	11:00	23:30
Wed	11:00	23:30
Thur	11:00	00:30
Fri	11:00	00:30
Sat	11:00	00:30
Sun	11:00	23:30

State any seasonal variations ( Please read guidance note 5 )

	none
--	------

Non standard timings. Where you intend to use the premises to be open to the public at different times from those listed. Please list, ( Please read guidance note 6 )

	none
--	------

M - Steps to promote four licencing objectives

a) General - all four licensing objectives (b,c,d,e) ( Please read guidance note 10 )

	The premises are located on the site of a previous licensed premises and in an area consisting of a number of licensed premises. the premises will be an up market restaurant and wine bar, appealing to the young professionals in the area. it is not deemed to be at high risk in relation to the licensing conditions. The proprietor, Ad Hoc Pubs Ltd, owns and runs a number of other similar establishments in London. the premises are well run and the owners have a good track record of compliance with licensing legislation and has a good working relationship with the respective licensing authorities.
--	---

b) the prevention of crime and disorder

	<p>The owners will abide by all mandatory conditions imposed. In addition, Each and every supply of alcohol under the premises licence will be made or authorised by a person who holds a personal licence.                  There will be Minimum drinks pricing                  There will be no irresponsible drinks promotions                  Alcohol to be supplied in accordance with weights and measurements legislation                  There will be a Strict no drugs policy. Anyone found with drugs on their person will be removed immediately form the premises and the police called.                  The premises will have a minimum of 16 CCTV cameras with additional hard drives. Footage will be retained for 2 months.</p>
--	--

c) public safety

	<p>Compliance with relevant legislation such as Health and safety at work Regulations 1999 and Reg. Reform (Fire Safety) Order 2005. The mezzanine level fully complies with child safety requirements imposed by building control. the barrier is 1.5m high with straight metal bars preventing small children from climbing up.</p> <p>Free drinking water available for consumption on premises                  Safe and designated outside smoking area.                  Provide information on local taxi firms                  Will sign up and comply with local authority's Women's Safety Charter (specifically mentioned in the local authority's guidance)</p>
--	--

d) the prevention of public nuisance

	<p>The premises are deemed to be a low risk of causing public nuisance. there is no outdoor area (apart from a small designated smoking area at the front curtilage of the premises).</p> <p>In addition to mandatory conditions the premises will</p> <p>Music (both live and recorded) will be background level only and will be restricted to 2230hrs.</p> <p>licence holder will ensure all external doors and windows are closed after 2100hrs to prevent noise and vibration escaping from the premises</p> <p>Maximum capacity of 120 and 10 for outside smoking area.</p> <p>Display of notices at exit points asking patrons to leave quietly</p> <p>will be provision to ring a taxi from the premises to avoid people congregating outside.</p>
--	--

e) the protection of children from harm

	<p>The premises are deemed to be low risk of danger to child safety. There is no gaming facilities on site, nor is permission sought to carry out adult entertainment on the premises.</p> <p>In addition to mandatory conditions the premises will carry out the following:</p> <p>The premises will have an age verification policy and All staff will be trained to implement and maintain it. A refusals book will be kept at the premises</p> <p>The premises will undertake a "challenge 21 policy"</p> <p>Under 16's not to be permitted entry unless accompanied by an adult</p>
--	--

Guidance note 10

Please list here steps you will take to promote all four licensing objectives together.

Please upload a plan of the premises

--	--

Please upload any additional information i.e. risk assessments

--	--

Checklist

	I have enclosed the plan of the premises. I understand that if I do not comply with the above requirements my application  will be rejected. I understand that I must now advertise my application (In the local paper within 14 days of applying
--	--

Home Office Declaration

Please tick to indicate agreement

	I am a company or limited liability partnership
--	---

Declaration

[Applicable to individual applicants only, including those in a partnership which is not a limited liability partnership]

I understand I am not entitled to be issued with a licence if I do not have the entitlement to live and work in the UK (or if I am subject to a condition preventing me from doing work relating to the carrying on of a licensable activity) and that my licence will become invalid if I cease to be entitled to live and work in the UK.

The DPS named in this application form is entitled to work in the UK (and is not subject to conditions preventing him or her from doing work relating to a licensable activity) and I have seen a copy of his or her proof of entitlement to work, or have conducted an online right to work check using the Home Office online right to work checking service which confirmed their right to work.

I/We hereby declare the information provided is true and accurate.

I agree to the above statement

PaymentDescription	, ,
PaymentAmountInMinorUnits	
AuthCode	



LicenceReference	██████████
PaymentContactEmail	

Please provide name of applicant (the current premises licence holder) or applicant's solicitor or other duly authorised agent (please read guidance note 12). If completing on behalf of the applicant, please state in what capacity.

Full name	Michael Balmer
Date (DD/MM/YYYY)	01/04/2022
Capacity	Applicants solicitor

Where the premises licence is jointly held, enter the 2nd applicant (the current premises licence holder) or 2nd applicant's solicitor or other authorised agent (guidance note 13). If completing on behalf of the applicant state in what capacity

Full name	
Date (DD/MM/YYYY)	
Capacity	

Contact name (where not previously given) an address for correspondence associated with this application (please read guidance note 14)

Contact name and address for correspondence	Michael Balmer Weightmans LLP No1 Spinningfields 1 Hardman Street Manchester M3 3EB
Telephone No.	01612331285
If you prefer us to correspond with you by e-mail, your email address (optional)	michael.balmer@weightmans.com

#### GUIDANCE NOTES

12. An applicant's agent (for example solicitor) may sign the form on their behalf provided that they have actual authority to do so.

13. Where there is more than one applicant, each of the applicants or their respective agents must sign the application form.

14. This is the address which we shall use to correspond with you about this application.

IT IS AN OFFENCE, UNDER SECTION 158 OF THE LICENSING ACT 2003, TO MAKE A FALSE STATEMENT IN OR IN CONNECTION WITH THIS APPLICATION. THOSE WHO MAKE A FALSE STATEMENT MAY BE LIABLE ON SUMMARY CONVICTION TO A FINE OF ANY AMOUNT.

IT IS AN OFFENCE UNDER SECTION 24B OF THE IMMIGRATION ACT 1971 FOR A PERSON TO WORK WHEN THEY KNOW, OR HAVE REASONABLE CAUSE TO BELIEVE, THAT THEY ARE DISQUALIFIED FROM DOING SO BY REASON OF THEIR IMMIGRATION STATUS. THOSE WHO EMPLOY AN ADULT WITHOUT LEAVE OR WHO IS SUBJECT TO CONDITIONS AS TO EMPLOYMENT WILL BE LIABLE TO A CIVIL PENALTY UNDER SECTION 15 OF THE IMMIGRATION, ASYLUM AND NATIONALITY ACT 2006 AND PURSUANT TO SECTION 21 OF THE SAME ACT, WILL BE COMMITTING AN OFFENCE WHERE THEY DO SO IN THE KNOWLEDGE, OR WITH REASONABLE CAUSE TO BELIEVE, THAT THE EMPLOYEE IS

DISQUALIFIED.

The information you provide will be used fairly and lawfully and Southwark Council will not knowingly do anything which may lead to a breach of the Data Protection Act 1998.

Gambia street

Scoresby street

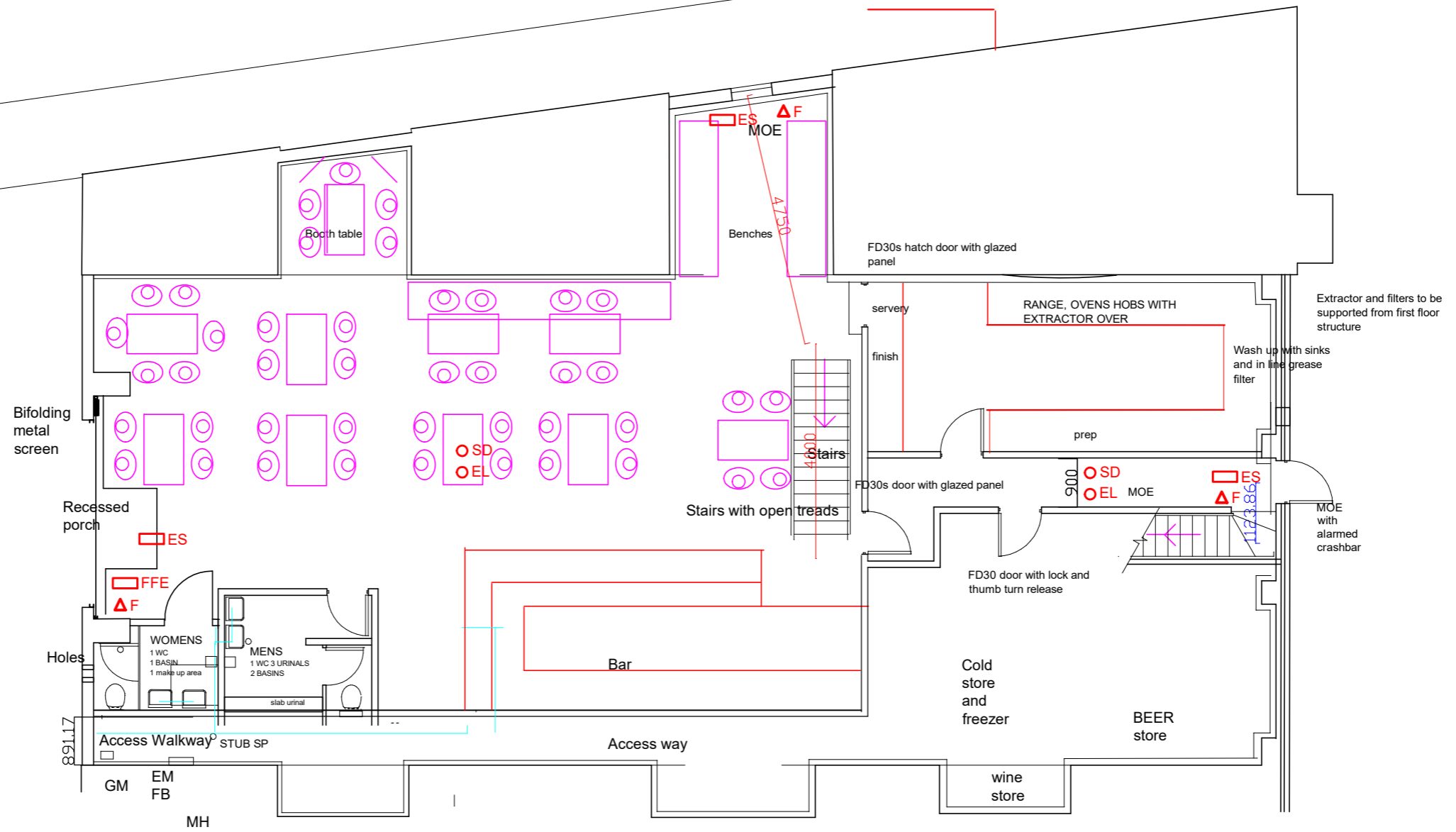

PROPOSED GROUND FLOOR PLAN MOE 1:100

- ☐ FFE
  - ▲ wc
  - ▲ CO2
  - ▲ AFFF
  - ▲ DP
  - ▲ WS
  - FB
  - SD
  - EL
  - ☐ ES
- ☐ FFE - Fire fighting equipment station
  - ▲ wc - wet chemical 6lt extinguisher
  - ▲ CO2 - Fire extinguisher
  - ▲ F - Foam Fire extinguisher
  - ▲ DP - Dry powder Fire extinguisher and sign
  - ▲ WS - water spray 6 lt Fire extinguisher
  - FB - Fire blanket and sign
  - SD - Smoke detector and alarm
  - EL - emergency light
  - ES - illuminated emergency exit sign

ALEX IMLACH DESIGN 02088779955  
 PROJECT: 80 Scoresby Street, London SE1 0XN  
 CLIENT: Tristan Angel  
 TITLE: Proposed Ground floor  
 SCALE: 1:100 DWG NO: 711/MOE/110 REV: A  
 Rev A - revised

500	1000	2000
Scale bar in mm		

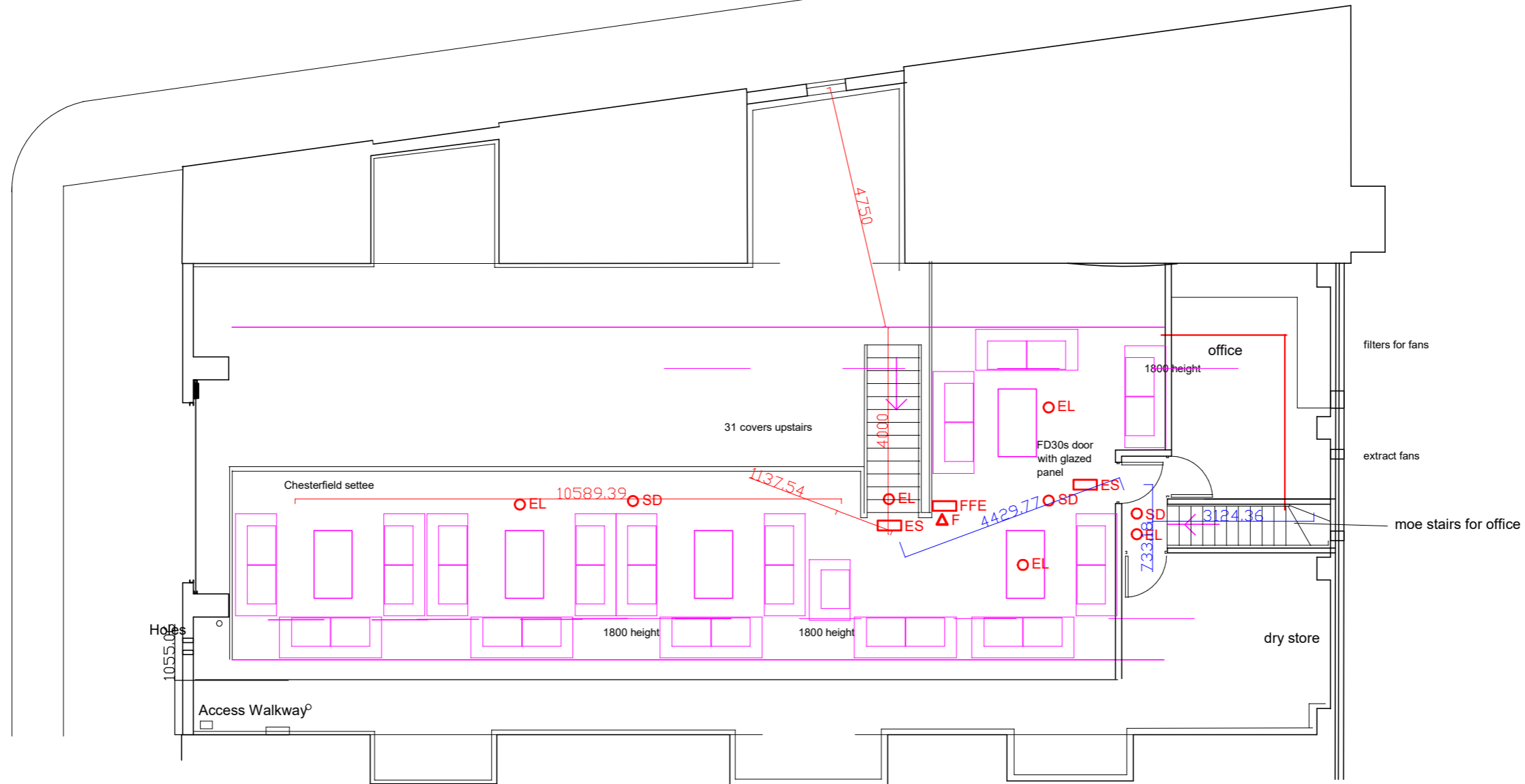

# PROPOSED MEZZANINE FLOOR PLAN MOE 1:100

ALEX IMLACH DESIGN 02088779955  
 PROJECT: 80 Scoresby Street, London SE1 0XN  
 CLIENT: Tristan Angel  
 TITLE: Proposed Mezzanine floor  
 SCALE: 1:100 DWG NO: 711/MOE/111 REV: A  
 Rev A - revised layout  
 500 1000 2000  
 Scale bar in mm 5000

- ☐ FFE - Fire fighting equipment station
- ▲ wc - wet chemical 6lt extinguisher
- ▲ CO2 - Fire extinguisher
- ▲ F - AFFF Foam Fire extinguisher
- ▲ DP - Dry powder Fire extinguisher and sign
- ▲ WS - water spray 6 lt Fire extinguisher
- FB - Fire blanket and sign
- SD - Smoke detector and alarm
- EL - emergency light
- ES - illuminated emergency exit sign