

Licensing Sub-Committee

Wednesday 17 February 2016

10.00 am

Ground Floor Meeting Room G02A - 160 Tooley Street, London SE1 2QH

Membership

Councillor Renata Hamvas (Chair)
Councillor Jon Hartley
Councillor Eliza Mann

Reserves

Councillor Adele Morris

INFORMATION FOR MEMBERS OF THE PUBLIC

Access to information

You have the right to request to inspect copies of minutes and reports on this agenda as well as the background documents used in the preparation of these reports.

Babysitting/Carers allowances

If you are a resident of the borough and have paid someone to look after your children, an elderly dependant or a dependant with disabilities so that you could attend this meeting, you may claim an allowance from the council. Please collect a claim form at the meeting.

Access

The council is committed to making its meetings accessible. Further details on building access, translation, provision of signers etc for this meeting are on the council's web site: www.southwark.gov.uk or please contact the person below.

Contact

Andrew Weir on 020 7525 7222 or email: andrew.weir@southwark.gov.uk
Webpage: www.southwark.gov.uk

Members of the committee are summoned to attend this meeting

Eleanor Kelly

Chief Executive

Date: 9 February 2016



Licensing Sub-Committee

Wednesday 17 February 2016

10.00 am

Ground Floor Meeting Room G02A - 160 Tooley Street, London SE1 2QH

Order of Business

Item No.	Title	Page No.
----------	-------	----------

PART A - OPEN BUSINESS

1. APOLOGIES

To receive any apologies for absence.

2. CONFIRMATION OF VOTING MEMBERS

A representative of each political group will confirm the voting members of the committee.

3. NOTIFICATION OF ANY ITEMS OF BUSINESS WHICH THE CHAIR DEEMS URGENT

In special circumstances, an item of business may be added to an agenda within five clear days of the meeting.

4. DISCLOSURE OF INTERESTS AND DISPENSATIONS

Members to declare any interests and dispensation in respect of any item of business to be considered at this meeting.

5. LICENSING ACT 2003: LAS CONGAS, 1ST FLOOR, 516 OLD KENT ROAD, LONDON SE1 5BA 1 - 41

ANY OTHER OPEN BUSINESS AS NOTIFIED AT THE START OF THE MEETING AND ACCEPTED BY THE CHAIR AS URGENT

Item No.

Title

Page No.

PART B - CLOSED BUSINESS

EXCLUSION OF PRESS AND PUBLIC

The following motion should be moved, seconded and approved if the sub-committee wishes to exclude the press and public to deal with reports revealing exempt information:

“That the public be excluded from the meeting for the following items of business on the grounds that they involve the likely disclosure of exempt information as defined in paragraphs 1-7, Access to Information Procedure rules of the Constitution.”

ANY OTHER CLOSED BUSINESS AS NOTIFIED AT THE START OF THE MEETING AND ACCEPTED BY THE CHAIR AS URGENT

Date: 9 February 2016

Item No. 5.	Classification: Open	Date: 17 February 2016	Meeting Name: Licensing sub-committee
Report title:		Licensing Act 2003: Las Congas, 1st Floor, 516 Old Kent Road, London SE1 5BA	
Ward(s) or groups affected:		East Walworth	
From:		Strategic Director of Environment and Leisure	

RECOMMENDATION

1. That the licensing sub-committee considers an application made by Las Congas Club Limited, for a premises licence to be granted under the Licensing Act 2003 in respect of the premises known as Las Congas, 1st Floor, 516 Old Kent Road, London SE1 5BA.
2. Notes:
 - a) This application forms a new application for a premises licence, submitted under Section 17 of the Licensing Act 2003. The application is subject to representations from responsible authorities and is therefore referred to the sub-committee for determination.
 - b) Paragraphs 8 to 11 of this report provide a summary of the application under consideration by the sub-committee. A copy of the full application is attached as Appendix A.
 - c) Paragraphs 12 to 22 of this report deals with the representations received to the application. Copies of the representations from responsible authorities are attached as Appendix B. Copies of correspondences from the conciliation process and map of the area are attached as Appendices C and D.
 - d) A copy of the council's approved procedure for hearings of the sub-committee in relation to an application made under the Licensing Act 2003, along with a copy of the hearing regulations, has been circulated to all parties to the meeting.

BACKGROUND INFORMATION

The Licensing Act 2003

3. The Licensing Act 2003 provides a licensing regime for:
 - The sale of and supply of alcohol
 - The provision of regulated entertainment
 - The provision of late night refreshment.
4. Within Southwark, the licensing responsibility is wholly administered by this council.

5. The Act requires the licensing authority to carry out its functions under the Act with a view to promoting the four stated licensing objectives. These are:
 - The prevention of crime and disorder
 - The promotion of public safety
 - The prevention of nuisance
 - The protection of children from harm.

6. In carrying out its licensing functions, a licensing authority must also have regard to
 - The Act itself
 - The guidance to the act issued under Section 182 of the Act
 - Secondary regulations issued under the Act
 - The licensing authority's own statement of licensing policy
 - The application, including the operating schedule submitted as part of the application
 - Relevant representations.

7. The premises licence application process involves the provision of all relevant information required under the Act to the licensing authority with copies provided by the applicant to the relevant responsible bodies under the Act. The application must also be advertised at the premises and in the local press. The responsible authorities and other persons within the local community may make representations on any part of the application where relevant to the four licensing objectives.

KEY ISSUES FOR CONSIDERATION

The premises licence application

8. On 24 December 2015, Las Congas Club Limited applied to this Council for the grant of a new premises licence in respect of the premises known as Las Congas, 1st Floor, 516 Old Kent Road, London SE1 5BA.

9. The application proposes to licence the first floor, which has two main areas for customers each with its own bar, dance area and DJ station. The smoking areas are located on the first floor landing and the ground floor.

The application is summarised as follows:

- Live Music (indoors):
 Monday and Tuesday from 09.00 to 02.00
 Wednesday from 09.00 to 04.00
 Thursday from 09.00 to 05.00
 Friday from 09.00 to 06.00
 Saturday from 11.00 to 10.00
 Sunday from 11.00 to 04.00

- Recorded Music (indoors):
 Monday and Tuesday from 09.00 to 02.00
 Wednesday from 09.00 to 04.00
 Thursday from 09.00 to 05.00
 Friday from 09.00 to 06.00
 Saturday from 11.00 to 10.00
 Sunday from 11.00 to 04.00

- Late night refreshment (indoors):
Monday and Tuesday from 23.00 to 02.00
Wednesday from 23.00 to 04.00
Thursday from 23.00 to 05.00
Friday from 23.00 to 06.00
Saturday from 23.00 to 10.00
Sunday from 23.00 to 04.00
 - The supply of alcohol (for consumption on and off the premises):
Monday and Tuesday from 09.00 to 02.00
Wednesday from 09.00 to 04.00
Thursday from 09.00 to 05.00
Friday from 09.00 to 06.00
Saturday from 11.00 to 10.00
Sunday from 11.00 to 04.00
 - Operating hours:
Monday and Tuesday from 09.00 to 02.30
Wednesday from 09.00 to 04.30
Thursday from 09.00 to 05.30
Friday from 09.00 to 06.30
Saturday from 11.00 to 10.30
Sunday from 11.00 to 04.30.
10. The premises licence application form provides the applicant operating schedule. Parts E, F, I, J, K, L, and M set out the proposed operating hours and operating controls in full, with reference to the four licensing objectives as stated in the Licensing Act 2003. Should a premises licence be issued in respect of the application the information provided in part M of the operating schedule will form the basis of conditions that will be attached to the licence. A copy of the application is attached to this report as Appendix A.

Designated premises supervisor

11. The proposed designated premises supervisor (DPS) is Maria Zahouani, who has a personal licence from Camden Council. Maria is also one of the licence holders for Tito's Bar, 4-6 London Bridge Street, London SE1

Representations from responsible authorities

12. Representations were submitted by three responsible authorities, (the police, environmental protection team (EPT) and the public health authority).
13. The police state that on examination of the applicants operating schedule, they are particularly concerned about the excessive opening hours from Saturday into Sunday and are suggesting the following hours are considered for the provision of licensable activities:

- Suggested opening hours:
Monday and Tuesday from 09.00 to 02.00
Wednesday and Thursday from 09.00 to 03.00
Friday and Saturday from 11.00 to 05.00
Sunday from 11.00 to 04.00.
14. The premises will be closed to the public 30 minutes after licensable activities have ceased.
15. They have also submitted ten conditions which are listed below as part of their representation.
- That SIA registered Door Supervisors, at least one of whom shall be a female, shall be employed at all times after 21.00 and the terminal hour that the premises are in use under this licence on each day of the week. At least one door supervisor will be provided with and will use hand held metal detection units in order to ensure that searches are carried out in respect of all admissions to the premises, whether members of the public or performers and their assistants. Mechanical counting devices will be used to ensure that the maximum accommodation limit of the premises is not exceeded and that at any given time the occupancy level of the venue is known and can be supplied to the authorities upon request
 - That the premises will install a CCTV system and maintain this system in good working order. The system will be of evidential quality and should be able to capture a clear facial image of all persons that enter the venue. That all CCTV footage shall be kept for a period of thirty one (31) days and shall, upon request, be made immediately available for inspection to officers of the police and the council
 - That there shall be at least one member of staff on duty at all times the premises are in operation under its licence trained and proficient in the operation of the CCTV system capable of operating and retrieving footage on request of the police or other authorised officers.
 - That the premises shall require any regular and external promoters or any other third parties hiring the premises to complete the 'venue hire agreement' provided by Southwark Police Licensing Unit and, once completed, the premises shall ensure that a copy of the agreement is provided to the police licensing unit a minimum of fourteen days prior to the date of hire.
 - That a personal licence holder is on the premises and on duty at all times that intoxicating liquor is supplied.
 - That on Monday and Tuesday after 00.30, on Wednesday and Thursday after 01.30, and on the Friday, Saturday and Sunday after 03.00 there shall be no new entry to the premises, other than those who leave the premises for the purpose of smoking a cigarette. Those persons shall be subject to a further search on re-entry to the premises.
 - That those that do leave the premises shall not be allowed to consume any beverages whilst outside.

- That an ID scanning system to the reasonable satisfaction of Police be installed and maintained at the premises. The system should be capable of sharing information about banned customers with other venues, identify the hologram of an ID and read both passports and ID cards, able to identify fake or forged ID documents to a reasonable standard. The system will be in operation at all times after 21:00 when the premises are in operation under the premises licence and will be used to record the details of all persons entering the premises including staff, members of the public, performers and their assistants. Entry to the premises will not be permitted without the production of the relevant ID document and or the person's details are already stored on the system and they are identified using a biometric identification system.
 - That at all times the premises is in operation under the premises licence there will be at least one member of staff trained to a satisfactory standard able to operate the ID scan system and able to retrieve data from the system on request of the Police or other authorised officer.
 - That all staff concerned in the sale or supply of intoxicating liquor undergoes a recognised training scheme for such duties. Records of such training should be kept and made available for inspection, on request by Police or other authorised officer.
16. The representation from the EPT is concerned that the applicant is requesting extremely late hours for licensable activities, running late into every night of the week and throughout the nights on Wednesdays to Sundays. They note that there are existing and currently new residential properties being built on the opposite side of the Old Kent Road to Las Congas.
17. The EPT consider that the current operating schedule proposed to address the 'prevention of public nuisance' licensing objective (section M part d) is poor and have serious concerns regarding this current application with regards to public nuisance.
18. The representation from the public health authority is concerned about the granting of an off-licence as part of the application. They are concerned that patrons who have been drinking for an extended period of time will leave the club with alcoholic beverages in hand. They also oppose the long hours of alcohol sales requested. In reference to the early start-times of 09.00 and 11.00 they would like to know whether food will be available at the premises.
19. The public health authority recommends that the on-licence and off-licence be considered separately and that the hours of the on-licence be based on whether or not the premises offer substantial food. If substantial food is offered then it is recommending the hours listed below:
- Suggested opening hours:
Sunday to Wednesday from 11.00 to 01:00
Thursday from 11.00 to 02.00
Friday and Saturday from 11.00 to 05.00.
20. If substantial food is not offered, then it is recommended that the start time of alcohol sales be 15.00 each day, and the end time of alcohol sales be as at the times stated in the aforementioned sentence.

21. However, if the committee were minded to grant the off-licence, It would request the hours of off-sales to be as listed and conditioned as below:
- Recommended hours for off licence:
Sunday to Thursday from 11.00 to 00.00
Friday and Saturday from 11.00 to 01.00
 - Proposed condition:
No beers, lagers, ciders or similar alcohols to be sold in cans with an Alcohol By Volume (ABV) in excess of 5% or in bottles larger than 750ml with an ABV in excess of 5%.
22. The representations are attached as Appendix B to the report.

Representations from other persons

23. There are no representations from other persons.

Conciliation

24. The applicant was forwarded the representations received and was advised to address the concerns within the representations submitted. A conciliation meeting took place on 1 February 2016 between the police, the EPT and the applicant at the premises.
25. The police state that during this meeting it became apparent that the premises intends to sell spirits by the bottle. This is a concern to them due to previous problems associated with high levels of intoxication associated with this as the premises have no control over who consumes the alcohol once sold. Even if the bottle is purchased for a group they would have no control measures stopping one person drinking or being able to monitor customer's levels of intoxication between drinks as customers would be pouring their own.
26. The police would like to see the following additional two conditions placed on the licence:
- That no spirits (alcohol containing more than 20% ABV) shall be sold by the bottle or half bottle.
 - That all spirits (alcohol containing more than 20% ABV) shall be sold by the measure of 25ml or 35ml at a maximum of two measures per container/glass
27. The EPT state that it was left to the applicant to go away and produce a thorough, detailed dispersal policy to review.
28. The EPT state that they would produce a list of relevant conditions regarding public nuisance and send it to the applicant for approval. This has not yet been done and should be ready before or on the scheduled hearing of 17 February 2016.
29. Emails detailing the above information submitted to applicant are attached as Appendix C.

Premises history

30. A premises licence was transferred on 2 January 2014 to Las Congas Bar Ltd.
31. The police notified the licensing unit that the then premises management company had changed but had failed to transfer the licence to the new company. Preliminary enquires into the licence holders with companies house discovered that the company holding the premises licence had been dissolved in August 2015 and the 28 days for the licence to be transferred had passed meaning that the licence no longer existed. They had been operating without a licence.
32. Temporary event notices were applied for during the Christmas period (18 to 20 December and 26 to 27 December 2015) by Maria Zahouani, the stated DPS. The police made representations to the notices but however withdrew after conducting meeting with Maria who runs Tito's in London Bridge. She was in the process of taking over Las Congas and was looking to have a trial period over Christmas before applying for a new licence.
33. She had a new security firm and new procedures in place and assured police she wanted to turn the venue around. In the spirit of the licensing act police to withdraw their representations.
34. The first event went ahead but issues of arose from previous clientele during closing hours and on the advice from the police and agreed by the management the second event scheduled for the 26 and 27 December 2015 was withdrawn.

Deregulation of entertainment

35. On 6 April 2015 entertainment became deregulated and as a result:
 - Live unamplified music is deregulated between 08.00 and 23.00 on any premises.
 - Live amplified music is deregulated between 08.00 and 23.00 provided the audience does not exceed 500 people.
36. However, live music can become licensable in on-licensed premises if the licensing authority removes the effect of the deregulation following a licence review ('licence review mechanism').

The local area

37. A map of the area is attached to this report as Appendix D. The premises is identified at the centre of the map. For purposes of scale only the circle on the map has a 100 metre radius:
 - Macdonalds Restaurant, 518 Old Kent Road, London SE1 (Monday to Sunday until 05.00).

Southwark council statement of licensing policy

38. Council assembly approved Southwark's statement of licensing policy 2011-14 on 12 October 2011. Sections of the statement that are considered to be of particular relevance to this application are:

- Section 3 which sets out the purpose and scope of the policy and reinforces the four licensing objectives
 - Section 5 which sets out the council's approach with regard to the imposition of conditions including mandatory conditions to be attached to the licence
 - Section 6 details other relevant council and government policies, strategies, responsibilities and guidance, including the relevant articles under the Human Rights Act 1998
 - Section 7 provides general guidance on dealing with crime and disorder and deals with licensing hours
 - Section 8 provides general guidance on ensuring public safety including safe capacities
 - Section 9 provides general guidance on the prevention of nuisance
 - Section 10 provides general guidance on the protection of children from harm.
39. The purpose of Southwark's statement of licensing policy is to make clear to applicants what considerations will be taken into account when determining applications and should act as a guide to the sub-committee when considering the applications. However, the sub-committee must always consider each application on its own merits and allow exceptions to the normal policy where these are justified by the circumstances of the application.

Resource implications

40. A fee of £190 has been paid by the applicant company in respect of this application being the statutory fee payable for premises within non-domestic rateable value band C.

Consultation

41. Consultation has been carried out on this application in accordance with the provisions of the Licensing Act 2003. A public notice was published in a local newspaper and a similar notice exhibited outside of the premises for a period of 28 consecutive days.

Community impact statement

42. Each application is required by law to be considered upon its own individual merits with all relevant matters taken into account.

SUPPLEMENTARY ADVICE FROM OTHER OFFICERS

Director of Law and Democracy

43. The sub-committee is asked to determine the application for a premises licence under section 17 of the Licensing Act 2003.
44. The principles which sub-committee members must apply are set out below.

Principles for making the determination

45. The general principle is that applications for premises licence applications must be granted unless relevant representations are received. This is subject to the proviso that the applicant has complied with regulations in advertising and submitting the application.
46. Relevant representations are those which:
- Are about the likely effect of the granting of the application on the promotion of the licensing objectives
 - Are made by an interested party or responsible authority
 - Have not been withdrawn
 - Are not, in the opinion of the relevant licensing authority, frivolous or vexatious
47. If relevant representations are received then the sub-committee must have regard to them, in determining whether it is necessary for the promotion of the licensing objectives to:
- To grant the licence subject to:
 - The conditions mentioned in section 18 (2)(a) modified to such extent as the licensing authority considers necessary for the promotion of the licensing objectives
 - Any condition which must under section 19, 20 or 21 be included in the licence
 - To exclude from the scope of the licence any of the licensable activities to which the application relates
 - To refuse to specify a person in the licence as the premises supervisor
 - To reject the application.

Conditions

48. The sub-committee's discretion is thus limited. It can only modify the conditions put forward by the applicant, or refuse the application, if it is necessary to do so. Conditions must be necessary and proportionate for the promotion of one of the four licensing objectives, and not for any other reason. Conditions must also be within the control of the licensee, and should be worded in a way which is clear, certain, consistent and enforceable.
49. The four licensing objectives are:
- The prevention of crime and disorder
 - Public safety
 - The prevention of nuisance
 - The protection of children from harm.
50. Members should note that each objective is of equal importance. There are no other licensing objectives, and the four objectives are paramount considerations at all times.
51. Conditions will not be necessary if they duplicate a statutory position. Conditions relating to night café and take away aspect of the license must relate to the night

time operation of the premises and must not be used to impose conditions which could not be imposed on day time operators.

52. Members are also referred to the Home Office Revised Guidance issued under section 182 of the Licensing Act 2003 on conditions, specifically section 10.

Reasons

53. If the sub-committee determines that it is necessary to modify the conditions, or to refuse the application for a premises licence application, it must give reasons for its decision.

Hearing procedures

54. Subject to the licensing hearing regulations, the licensing committee may determine its own procedures. Key elements of the regulations are that:

- The hearing shall take the form of a discussion led by the authority. Cross examination shall not be permitted unless the authority considered that it is required for it to consider the representations.
- Members of the authority are free to ask any question of any party or other person appearing at the hearing.
- The committee must allow the parties an equal maximum period of time in which to exercise their rights to:
 - Address the authority
 - If given permission by the committee, question any other party.
 - In response to a point which the authority has given notice it will require clarification, give further information in support of their application.
- The committee shall disregard any information given by a party which is not relevant to the particular application before the committee and the licensing objectives.
- The hearing shall be in public, although the committee may exclude the public from all or part of a hearing where it considers that the public interest in doing so outweighs the public interest in the hearing, or that part of the hearing, taking place in private.
- In considering any representations or notice made by a party the authority may take into account documentary or other information produced by a party in support of their application, representations or notice (as applicable) either before the hearing or, with the consent of all the other parties, at the hearing.

55. This matter relates to the determination of an application for a premises licence under section 17 of the Licensing Act 2003. Regulation 26(1) (a) requires the sub-committee to make its determination at the conclusion of the hearing.

Council's multiple roles and the role of the licensing sub-committee

56. Sub-committee members will note that, in relation to this application, the council has multiple roles. Council officers from various departments have been asked to

consider the application from the perspective of the council as authority responsible respectively for environmental health, trading standards, health and safety and as the planning authority.

57. Members should note that the licensing sub-committee is meeting on this occasion solely to perform the role of licensing authority. The sub-committee sits in quasi-judicial capacity, and must act impartially. It must offer a fair and unbiased hearing of the application. In this case, members should disregard the council's broader policy objectives and role as statutory authority in other contexts. Members must direct themselves to making a determination solely based upon the licensing law, guidance and the council's statement of licensing policy.
58. As a quasi-judicial body the licensing sub-committee is required to consider the application on its merits. The sub-committee must take into account only relevant factors, and ignore irrelevant factors. The decision must be based on evidence, that is to say material, which tends logically to show the existence or non-existence of relevant facts, or the likelihood or unlikelihood of the occurrence of some future event, the occurrence of which would be relevant. The licensing sub-committee must give fair consideration to the contentions of all persons entitled to make representations to them.
59. The licensing sub-committee is entitled to consider events outside of the premises if they are relevant, i.e. are properly attributable to the premises being open. The proprietors do not have to be personally responsible for the incidents for the same to be relevant. However, if such events are not properly attributable to the premises being open, then the evidence is not relevant and should be excluded. Guidance is that the licensing authority will primarily focus on the direct impact of the activities taking place at the licensed premises on members of the public, living, working or engaged in normal activity in the area concerned.
60. Members will be aware of the council's code of conduct which requires them to declare personal and prejudicial interests. The code applies to members when considering licensing applications. In addition, as a quasi-judicial body, members are required to avoid both actual bias, and the appearance of bias.
61. The sub-committee can only consider matters within the application that have been raised through representations from other persons and responsible authorities. Other persons must live in the vicinity of the premises. This will be decided on a case to case basis.
62. Under the Human Rights Act 1998, the sub-committee needs to consider the balance between the rights of the applicant and those making representations to the application when making their decision. The sub-committee has a duty under section 17 Crime and Disorder Act 1998 when making its decision to do all it can to prevent crime and disorder in the borough.
63. Other persons, responsible authorities and the applicant have the right to appeal the decision of the sub-committee to the Magistrates' Court within a period of 21 days beginning with the day on which the applicant was notified by the licensing authority of the decision to be appealed against.

Guidance

64. Members are required to have regard to the Department for Culture, Media and Sport guidance in carrying out the functions of licensing authority. However,

guidance does not cover every possible situation, so long as the guidance has been properly and carefully understood, members may depart from it if they have reason to do so. Full reasons must be given if this is the case

BACKGROUND DOCUMENTS

Background Papers	Held At	Contact
Licensing Act 2003 DCMS Guidance to the Act Secondary Regulations Southwark statement of licensing Policy Case file	Southwark Licensing, C/O Community Safety & Enforcement, 160 Tooley Street, London, SE1 2QH	Kirty Read Tel: 020 7525 5748

APPENDICES

Name	Title
Appendix A	Premises licence application
Appendix B	Representations from responsible authorities
Appendix C	Further emails from responsible authorities
Appendix D	Map of the local area

AUDIT TRAIL

Lead Officer	Deborah Collins, Strategic Director of Environment and Leisure	
Report Author	Dorcas Mills, Principal Licensing Officer	
Version	Final	
Dated	5 February 2016	
Key Decision?	No	
CONSULTATION WITH OTHER OFFICERS / DIRECTORATES / CABINET MEMBER		
Officer Title	Comments sought	Comments included
Director of Law and Democracy	Yes	Yes
Strategic Director of Finance and Governance	No	No
Cabinet Member	No	No
Date final report sent to Constitutional Team	5 February 2016	

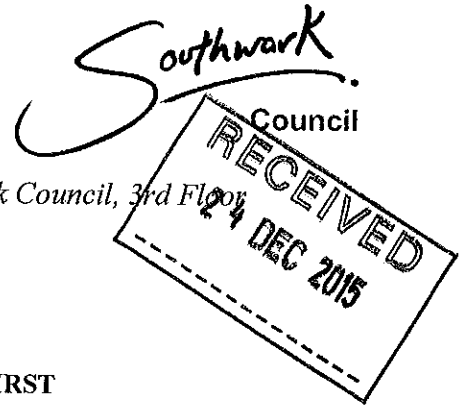

Community Safety EHTS, Health Safety & Licensing Team, Southwark Council, 3rd Floor
Hub 2, P O BOX 65429, London, SE1P 5LX

**Application for a premises licence to be granted
under the Licensing Act 2003**

PLEASE READ THE FOLLOWING INSTRUCTIONS FIRST

Before completing this form please read the guidance notes at the end of the form. If you are completing this form by hand please write legibly in block capitals. In all cases ensure that your answers are inside the boxes and written in black ink. Use additional sheets if necessary.

You may wish to keep a copy of the completed form for your records.

I/We LAS CONGAS CLUB LIMITED

(Insert name(s) of applicant)

apply for a premises licence under section 17 of the Licensing Act 2003 for the premises described in Part 1 below (the premises) and I/we are making this application to you as the relevant licensing authority in accordance with section 12 of the Licensing Act 2003

Part 1 – Premises Details

Postal address of premises or, if none, ordnance survey map reference or description LAS CONGAS, 516 FIRST FLOOR OLD KENT ROAD,			
Post town	LONDON	Postcode	SE1 5BA
Telephone number at premises (if any)	[REDACTED]		
Non-domestic rateable value of premises	£ 17250.00		

Part 2 - Applicant Details

Please state whether you are applying for a premises licence as

Please tick as appropriate

- a) an individual or individuals * please complete section (A)
- b) a person other than an individual *
- i. as a limited company please complete section (B)
- ii. as a partnership please complete section (B)
- iii. as an unincorporated association or please complete section (B)
- iv. other (for example a statutory corporation) please complete section (B)

- c) a recognised club please complete section (B)
- d) a charity please complete section (B)
- e) the proprietor of an educational establishment please complete section (B)
- f) a health service body please complete section (B)
- g) a person who is registered under Part 2 of the Care Standards Act 2000 (c14) in respect of an independent hospital in Wales please complete section (B)
- ga) a person who is registered under Chapter 2 of Part 1 of the Health and Social Care Act 2008 (within the meaning of that Part) in an independent hospital in England please complete section (B)
- h) the chief officer of police of a police force in England and Wales please complete section (B)

* If you are applying as a person described in (a) or (b) please confirm:

Please tick yes

I am carrying on or proposing to carry on a business which involves the use of the premises for licensable activities; or

I am making the application pursuant to a
 statutory function or
 a function discharged by virtue of Her Majesty's prerogative

(A) INDIVIDUAL APPLICANTS (fill in as applicable)

Mr <input type="checkbox"/>	Mrs <input type="checkbox"/>	Miss <input type="checkbox"/>	Ms <input type="checkbox"/>	Other Title (for example, Rev)	
Surname			First names		
I am 18 years old or over				<input type="checkbox"/> Please tick yes	
Current postal address if different from premises address					
Post town				Postcode	
Daytime contact telephone number					
E-mail address (optional)					

SECOND INDIVIDUAL APPLICANT (if applicable)

Mr <input type="checkbox"/>	Mrs <input type="checkbox"/>	Miss <input type="checkbox"/>	Ms <input type="checkbox"/>	Other Title (for example, Rev)	
Surname			First names		
I am 18 years old or over				<input type="checkbox"/>	Please tick yes
Current postal address if different from premises address					
Post town				Postcode	
Daytime contact telephone number					
E-mail address (optional)					

(B) OTHER APPLICANTS

Please provide name and registered address of applicant in full. Where appropriate please give any registered number. In the case of a partnership or other joint venture (other than a body corporate), please give the name and address of each party concerned.

Name	LAS CONGAS CLUB LIMITED
Address	FIRST FLOOR, 16 MASSETTS ROAD, HORLEY, SURREY, RH6 7DE
Registered number (where applicable)	09878352
Description of applicant (for example, partnership, company, unincorporated association etc.)	COMPANY
Telephone number (if any)	
E-mail address (optional)	

Part 3 Operating Schedule

When do you want the premises licence to start?

DD	MM	YYYY
<input type="text"/>	<input type="text"/>	<input type="text"/>

If you wish the licence to be valid only for a limited period, when do you want it to end?

DD	MM	YYYY
<input type="text"/>	<input type="text"/>	<input type="text"/>

Please give a general description of the premises (please read guidance note 1)

The premises are on the first floor. There are 2 main areas for customers, each with its own bar, dance areas and DJ station. Each has its own mens and womens toilets.
 There are 5 fire exits.
 There is a smoking area on the first floor landing and one on the ground floor.
 There is an area for searches and ID checks at the entrance.
 Outside there is a Courtyard.
 There are 18 recording cameras.

If 5,000 or more people are expected to attend the premises at any one time, please state the number expected to attend.

What licensable activities do you intend to carry on from the premises?

(Please see sections 1 and 14 of the Licensing Act 2003 and Schedules 1 and 2 to the Licensing Act 2003)

Provision of regulated entertainment

Please tick any that apply

- | | |
|-------------------------------------------------------------------------------------------------------------|-------------------------------------|
| a) plays (if ticking yes, fill in box A) | <input type="checkbox"/> |
| b) films (if ticking yes, fill in box B) | <input type="checkbox"/> |
| c) indoor sporting events (if ticking yes, fill in box C) | <input type="checkbox"/> |
| d) boxing or wrestling entertainment (if ticking yes, fill in box D) | <input type="checkbox"/> |
| e) live music (if ticking yes, fill in box E) | <input checked="" type="checkbox"/> |
| f) recorded music (if ticking yes, fill in box F) | <input checked="" type="checkbox"/> |
| g) performances of dance (if ticking yes, fill in box G) | <input type="checkbox"/> |
| h) anything of a similar description to that falling within (e), (f) or (g) (if ticking yes, fill in box H) | <input type="checkbox"/> |

Provision of late night refreshment (if ticking yes, fill in box I)

Supply of alcohol (if ticking yes, fill in box J)

In all cases complete boxes K, L and M

A

Plays Standard days and timings (please read guidance note 6)			<u>Will the performance of a play take place indoors or outdoors or both – please tick</u> (please read guidance note 2)	Indoors	<input type="checkbox"/>
Day	Start	Finish		Outdoors	<input type="checkbox"/>
				Both	<input type="checkbox"/>
Mon			<u>Please give further details here</u> (please read guidance note 3)		
Tue					
Wed			<u>State any seasonal variations for performing plays</u> (please read guidance note 4)		
Thur					
Fri			<u>Non standard timings. Where you intend to use the premises for the performance of plays at different times to those listed in the column on the left, please list</u> (please read guidance note 5)		
Sat					
Sun					

B

Films Standard days and timings (please read guidance note 6)			<u>Will the exhibition of films take place indoors or outdoors or both – please tick</u> (please read guidance note 2)	Indoors	<input type="checkbox"/>
				Outdoors	<input type="checkbox"/>
				Both	<input type="checkbox"/>
Day	Start	Finish	<u>Please give further details here</u> (please read guidance note 3)		
Mon					
Tue					
Wed			<u>State any seasonal variations for the exhibition of films</u> (please read guidance note 4)		
Thur					
Fri			<u>Non standard timings. Where you intend to use the premises for the exhibition of films at different times to those listed in the column on the left, please list</u> (please read guidance note 5)		
Sat					
Sun					

C

Indoor sporting events Standard days and timings (please read guidance note 6)			<u>Please give further details</u> (please read guidance note 3)
Day	Start	Finish	
Mon			
Tue			<u>State any seasonal variations for indoor sporting events</u> (please read guidance note 4)
Wed			
Thur			<u>Non standard timings. Where you intend to use the premises for indoor sporting events at different times to those listed in the column on the left, please list</u> (please read guidance note 5)
Fri			
Sat			
Sun			

D

Boxing or wrestling entertainments Standard days and timings (please read guidance note 6)			<u>Will the boxing or wrestling entertainment take place indoors or outdoors or both – please tick</u> (please read guidance note 2)	Indoors	<input type="checkbox"/>
Day	Start	Finish		Outdoors	<input type="checkbox"/>
Day	Start	Finish		Both	<input type="checkbox"/>
Mon			<u>Please give further details here</u> (please read guidance note 3)		
Tue					
Wed			<u>State any seasonal variations for boxing or wrestling entertainment</u> (please read guidance note 4)		
Thur					
Fri			<u>Non standard timings. Where you intend to use the premises for boxing or wrestling entertainment at different times to those listed in the column on the left, please list</u> (please read guidance note 5)		
Sat					
Sun					

E

Live music Standard days and timings (please read guidance note 6)			Will the performance of live music take place <u>indoors or outdoors or both – please tick</u> (please read guidance note 2)	Indoors	<input checked="" type="checkbox"/>
Day	Start	Finish		Outdoors	<input type="checkbox"/>
Mon	09:00	02:00	Please give further details here (please read guidance note 3) A band will be invited to play occasionally.	Both	<input type="checkbox"/>
Tue	09:00	02:00			
Wed	09:00	04:00	State any seasonal variations for the performance of live music (please read guidance note 4) It will only be occasional. Recorded music is the primary form of entertainment.		
Thur	09:00	05:00			
Fri	09:00	06:00	Non standard timings. Where you intend to use the premises for the <u>performance of live music at different times to those listed in the column on the left, please list</u> (please read guidance note 5) It will be occasional.		
Sat	11:00	10:00			
Sun	11:00	04:00			

F

Recorded music Standard days and timings (please read guidance note 6)			Will the playing of recorded music take place <u>indoors or outdoors or both – please tick</u> (please read guidance note 2)	Indoors	<input checked="" type="checkbox"/>
				Outdoors	<input type="checkbox"/>
				Both	<input type="checkbox"/>
Day	Start	Finish	<u>Please give further details here</u> (please read guidance note 3)		
Mon	09:00	02:00			
Tue	09:00	02:00			
Wed	09:00	04:00			
Thur	09:00	05:00			
Fri	08:00	06:00			
Sat	11:00	10:00			
Sun	11:00	04:00			

State any seasonal variations for the playing of recorded music (please read guidance note 4)

Non standard timings. Where you intend to use the premises for the playing of recorded music at different times to those listed in the column on the left, please list (please read guidance note 5)

G

Performances of dance Standard days and timings (please read guidance note 6)			<u>Will the performance of dance take place indoors or outdoors or both – please tick</u> (please read guidance note 2)	Indoors	<input type="checkbox"/>
Day	Start	Finish		Outdoors	<input type="checkbox"/>
				Both	<input type="checkbox"/>
Mon			<u>Please give further details here</u> (please read guidance note 3)		
Tue					
Wed			<u>State any seasonal variations for the performance of dance</u> (please read guidance note 4)		
Thur					
Fri			<u>Non standard timings. Where you intend to use the premises for the performance of dance at different times to those listed in the column on the left, please list</u> (please read guidance note 5)		
Sat					
Sun					

H

<p>Anything of a similar description to that falling within (e), (f) or (g) Standard days and timings (please read guidance note 6)</p>			<p>Please give a description of the type of entertainment you will be providing</p>		
Day	Start	Finish	<p><u>Will this entertainment take place indoors or outdoors or both – please tick</u> (please read guidance note 2)</p>	Indoors	<input type="checkbox"/>
Mon				Outdoors	<input type="checkbox"/>
Tue			<p><u>Please give further details here</u> (please read guidance note 3)</p>		
Wed					
Thur			<p><u>State any seasonal variations for entertainment of a similar description to that falling within (e), (f) or (g)</u> (please read guidance note 4)</p>		
Fri					
Sat			<p><u>Non standard timings. Where you intend to use the premises for the entertainment of a similar description to that falling within (e), (f) or (g) at different times to those listed in the column on the left, please list</u> (please read guidance note 5)</p>		
Sun					

I

Late night refreshment Standard days and timings (please read guidance note 6)			Will the provision of late night refreshment take place indoors or outdoors or both – please tick (please read guidance note 2)	Indoors	<input checked="" type="checkbox"/>
Day	Start	Finish		Outdoors	<input type="checkbox"/>
Mon	23:00	02:00	<u>Please give further details here</u> (please read guidance note 3)	Both	<input type="checkbox"/>
Tue	23:00	02:00			
Wed	23:00	04:00	<u>State any seasonal variations for the provision of late night refreshment</u> (please read guidance note 4)		
Thur	23:00	05:00			
Fri	23:00	06:00	<u>Non standard timings. Where you intend to use the premises for the provision of late night refreshment at different times, to those listed in the column on the left, please list</u> (please read guidance note 5)		
Sat	23:00	10:00			
Sun	23:00	04:00			

J

Supply of alcohol Standard days and timings (please read guidance note 6)			<u>Will the supply of alcohol be for consumption – please tick</u> (please read guidance note 7)	On the premises	<input checked="" type="checkbox"/>
				Off the premises	<input checked="" type="checkbox"/>
				Both	<input type="checkbox"/>
Day	Start	Finish	<u>State any seasonal variations for the supply of alcohol</u> (please read guidance note 4)		
Mon	09:00	02:00			
Tue	09:00	02:00			
Wed	09:00	04:00			
Thur	09:00	05:00			
Fri	09:00	06:00			
Sat	11:00	10:00			
Sun	11:00	04:00			
			<u>Non standard timings. Where you intend to use the premises for the supply of alcohol at different times to those listed in the column on the left, please list</u> (please read guidance note 5)		

State the name and details of the individual whom you wish to specify on the licence as designated premises supervisor:

Name	Maria Zehouani
Address	[REDACTED]
Postcode	[REDACTED]
Personal licence number (if known)	[REDACTED]
Issuing licensing authority (if known)	Camden

K

Please highlight any adult entertainment or services, activities, other entertainment or matters ancillary to the use of the premises that may give rise to concern in respect of children (please read guidance note 8).

L

<p>Hours premises are open to the public Standard days and timings (please read guidance note 6)</p>	<p><u>State any seasonal variations</u> (please read guidance note 4)</p>																								
<table border="1" style="width: 100%; border-collapse: collapse;"> <thead> <tr> <th style="width: 15%;">Day</th> <th style="width: 35%;">Start</th> <th style="width: 35%;">Finish</th> </tr> </thead> <tbody> <tr> <td style="text-align: center;">Mon</td> <td style="text-align: center;">09:00</td> <td style="text-align: center;">02:30</td> </tr> <tr> <td style="text-align: center;">Tue</td> <td style="text-align: center;">09:00</td> <td style="text-align: center;">02:30</td> </tr> <tr> <td style="text-align: center;">Wed</td> <td style="text-align: center;">09:00</td> <td style="text-align: center;">04:30</td> </tr> <tr> <td style="text-align: center;">Thur</td> <td style="text-align: center;">09:00</td> <td style="text-align: center;">05:30</td> </tr> <tr> <td style="text-align: center;">Fri</td> <td style="text-align: center;">09:00</td> <td style="text-align: center;">06:30</td> </tr> <tr> <td style="text-align: center;">Sat</td> <td style="text-align: center;">11:00</td> <td style="text-align: center;">10:30</td> </tr> <tr> <td style="text-align: center;">Sun</td> <td style="text-align: center;">11:00</td> <td style="text-align: center;">04:30</td> </tr> </tbody> </table>	Day	Start	Finish	Mon	09:00	02:30	Tue	09:00	02:30	Wed	09:00	04:30	Thur	09:00	05:30	Fri	09:00	06:30	Sat	11:00	10:30	Sun	11:00	04:30	<p><u>Non standard timings. Where you intend the premises to be open to the public at different times from those listed in the column on the left, please list</u> (please read guidance note 5)</p>
Day	Start	Finish																							
Mon	09:00	02:30																							
Tue	09:00	02:30																							
Wed	09:00	04:30																							
Thur	09:00	05:30																							
Fri	09:00	06:30																							
Sat	11:00	10:30																							
Sun	11:00	04:30																							

M Describe the steps you intend to take to promote the four licensing objectives:

a) General-all four licensing objectives (b, c, d and e) (please read guidance note 9)

Strong management controls and effective training of all staff so that they are aware of the premises licence and the requirements to meet the four licensing objectives with particular attention to:

- a) No selling of alcohol to underage people
- b) no drunk and disorderly behaviour on the premises area
- c) vigilance in preventing the use and sale of illegal drugs at the retail area
- d) no violent and anti-social behaviour
- e) no harm to children

Clear "Challenge 25" information to prevent the supply of alcohol to under-age drinkers.

CCTV system installed with recording option available

We operate a nightclub at London Bridge and other restaurant/licensed premises and know that it is necessary to carry out our functions and operate the business with a purpose of promoting these objectives.

b) The prevention of crime and disorder

CCTV System installed with 18 recording cameras.

SIA registered door supervisors (at least one of whom is female)

Hand held metal detection units to search on admissions.

Notice warning of potential criminal activity, such as theft, that may target customers will be displayed.

Not selling of alcohol to drunk or intoxicated customers.

Vigilance in illegal drug use at the retail unit area

ID scan system installed

c) Public Safety

No new entry or re-entry after 02:00 on the morning following Wednesday, Thursday and Friday nights and after 05:00 on the morning following Saturday night.

Signs to say Drugs Free Zone.

A no search, no entry policy.

A limit on the use of glass within the premises

d) The prevention of public nuisance

Sound limiting device

Notices requesting people leave in a quiet and orderly fashion

The premises licence holder shall join and support a local Pub Watch Scheme (should there be one)

We have decided to limit the age to persons over 21 years.

e) The Protection of children from harm

"Challenge 25" sign which is a retailing strategy that encourages anyone who is over 18 but looks under 25 to carry ID in an approved form if they wish to buy alcohol. Well trained staff about requirement for persons' identification, age establishment etc.

A register of refused sales of alcohol to be kept.

Checklist:

Please tick to indicate agreement

- I have made or enclosed payment of the fee.
- I have enclosed the plan of the premises.
- I have sent copies of this application and the plan to responsible authorities and others where applicable.
- I have enclosed the consent form completed by the individual I wish to be designated premises supervisor, if applicable.
- I understand that I must now advertise my application.
- I understand that if I do not comply with the above requirements my application will be rejected.

IT IS AN OFFENCE, LIABLE ON SUMMARY CONVICTION TO A FINE NOT EXCEEDING LEVEL 5 ON THE STANDARD SCALE, UNDER SECTION 158 OF THE LICENSING ACT 2003, TO MAKE A FALSE STATEMENT IN OR IN CONNECTION WITH THIS APPLICATION.

Part 4 – Signatures (please read guidance note 10)

Signature of applicant or applicant’s solicitor or other duly authorised agent (see guidance note 11).
 If signing on behalf of the applicant, please state in what capacity.

Signature	[REDACTED]
Date	18-12-2015
Capacity	

For joint applications, signature of 2nd applicant or 2nd applicant’s solicitor or other authorised agent (please read guidance note 12). **If signing on behalf of the applicant, please state in what capacity.**

Signature	
Date	
Capacity	

Contact name (where not previously given) and postal address for correspondence associated with this application (please read guidance note 13)			
MARIA ZAHOUANI [REDACTED] [REDACTED]			
Post town	LONDON	Postcode	[REDACTED]
Telephone number (if any)	[REDACTED]	[REDACTED]	[REDACTED]
If you would prefer us to correspond with you by [REDACTED]			
MARIA ZAHOUANI [REDACTED]			

Notes for Guidance

1. Describe the premises, for example the type of premises, its general situation and layout and any other information which could be relevant to the licensing objectives. Where your application includes off-supplies of alcohol and you intend to provide a place for consumption of these off-supplies, you must include a description of where the place will be and its proximity to the premises.
2. Where taking place in a building or other structure please tick as appropriate (indoors may include a tent).
3. For example the type of activity to be authorised, if not already stated, and give relevant further details, for example (but not exclusively) whether or not music will be amplified or unamplified.
4. For example (but not exclusively), where the activity will occur on additional days during the summer months.
5. For example (but not exclusively), where you wish the activity to go on longer on a particular day e.g. Christmas Eve.
6. Please give timings in 24 hour clock (e.g. 16:00) and only give details for the days of the week when you intend the premises to be used for the activity.
7. If you wish people to be able to consume alcohol on the premises, please tick 'on the premises'. If you wish people to be able to purchase alcohol to consume away from the premises, please tick 'off the premises'. If you wish people to be able to do both, please tick 'both'.
8. Please give information about anything intended to occur at the premises or ancillary to the use of the premises which may give rise to concern in respect of children, regardless of whether you intend children to have access to the premises, for example (but not exclusively) nudity or semi-nudity, films for restricted age groups or the presence of gaming machines.
9. Please list here steps you will take to promote all four licensing objectives together.
10. The application form must be signed.
11. An applicant's agent (for example solicitor) may sign the form on their behalf provided that they have actual authority to do so.
12. Where there is more than one applicant, each of the applicant or their respective agent must sign the application form.
13. This is the address which we shall use to correspond with you about this application.

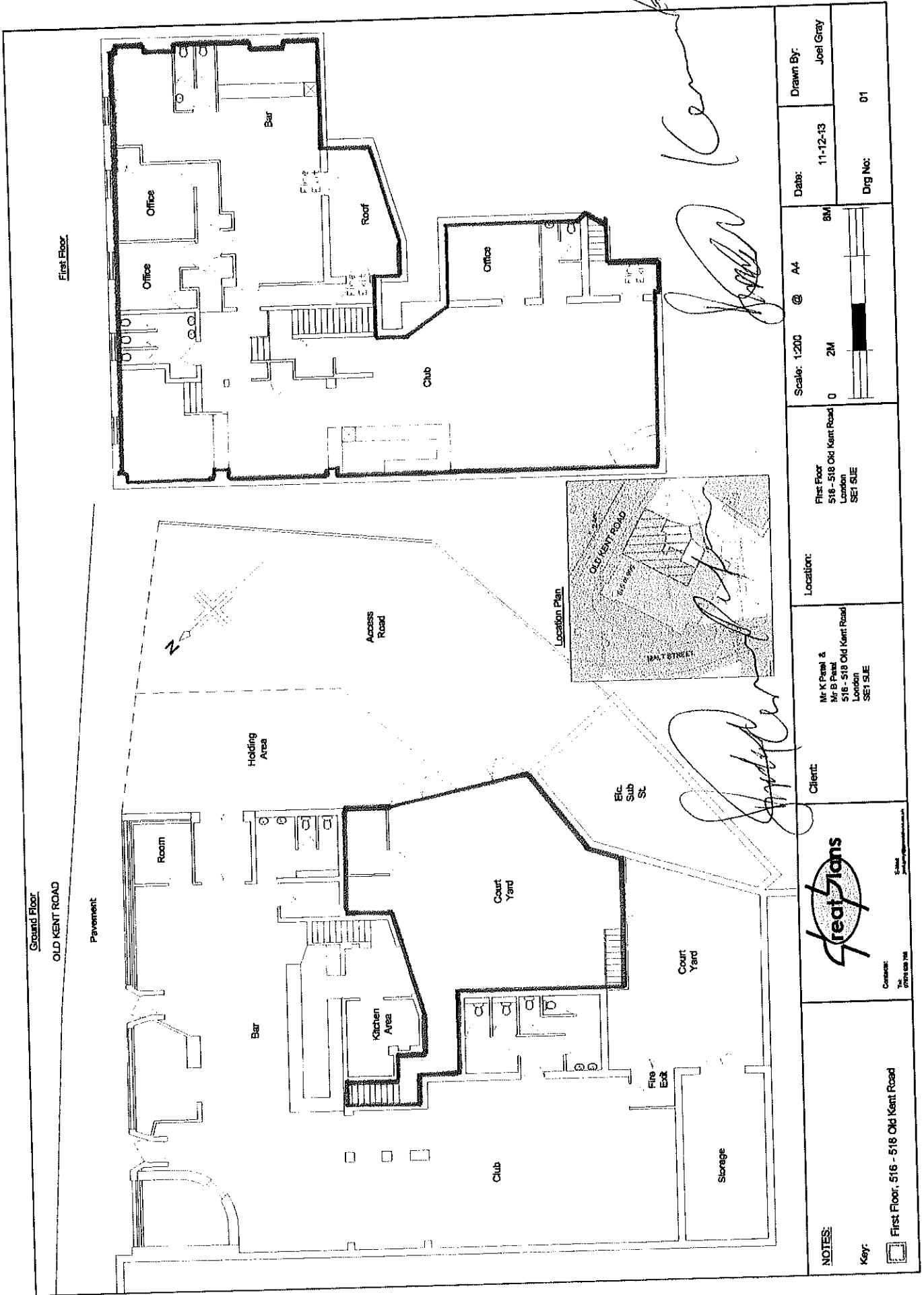

NOTES:

Key: First Floor, 516 - 518 Old Kent Road

Client: Mr K Patel & Mr B Patel
516 - 518 Old Kent Road
London
SE1 5LE

Location: First Floor
516 - 518 Old Kent Road
London
SE1 5LE

Scale: 1:200 @ A4

0 2M 8M

Date: 11-12-13

Drawn By: Joel Gray

Dirg No: 01

Handwritten signature/initials

Handwritten signature

Your reference: .



Our reference: MD/21/2740/16

Date: 20th January 2016

The Licensing Unit
Floor 3
160 Tooley Street
London
SE1 2QH

Metropolitan Police Service
Licensing Office
Southwark Police Station
323 Borough High Street
LONDON,
SE1 2ER

Tel: 020 -7232 6756

Dear Sir/Madam

Las Congas First Floor 512-516 old kent Road SE1 5BA

Police are in receipt of an application from the above for a new premises licence under the Licensing Act 2003.

I have met with the applicants to discuss the application, in particular I was concerned with what I considered to be excessive opening hours from Saturday into Sunday.

After discussions with the applicants I am suggesting the following hours are considered for the provision of licensable activities.

Mon - Tue	09:00 to 02:00
Wed -Thu	09:00 to 03:00
Fri - Sat	11:00 to 05:00
Sun	11:00 to 04:00

The premises will be closed to the public 30 minutes after licensable activities have ceased.

For the promotion of the licensing objectives, in particular the prevention of crime and disorder I am suggesting the following control measures, a number of which the applicants have already agreed and offered.

1. That SIA registered Door Supervisors, at least one of whom shall be a female, shall be employed at **all** times after 21.00hrs and the terminal hour that the premises are in use under this licence on each day of the week. At least one door supervisor will be provided with and will use hand held metal detection units in order to ensure that searches are carried out in respect of all admissions to the premises, whether members of the public or performers and their assistants. Mechanical counting devices will be used to ensure that the maximum accommodation limit of the premises is not exceeded and that at any given time the occupancy level of the venue is known and can be supplied to the authorities upon request
2. The premises will install a CCTV system and maintain this system in good working order, the system will be of evidential quality and should be able to capture a clear facial image of all persons that enter the venue. That all CCTV footage shall be kept for a period of thirty one (31) days and shall, upon request, be made immediately available for inspection to Officers of the Police and the Council
3. There shall be at least one member of staff on duty at all times the premises are in operation under its licence trained and proficient in the operation of the CCTV system capable of operating and retrieving footage on request of the Police or other authorised officer.
4. That you shall require any regular and external promoters or any other 3rd parties hiring the premises to complete the 'Venue Hire Agreement' provided by Southwark Police Licensing unit and, once completed, you shall ensure that a copy of the agreement is provided to the Police Licensing Unit a minimum of fourteen days prior to the date of hire.
5. That a Personal Licence holder is on the premises and on duty at **all** times that intoxicating liquor is supplied.
6. On Monday and Tuesday after 00:30, on Wednesday and Thursday after 01:30, and on the Friday, Saturday and Sunday after 03:00 there shall be no new entry to the premises, other than those who leave the premises for the purpose of smoking a cigarette, those persons shall be subject to a further search on re-entry to the premises.
7. Those that do leave the premises shall not be allowed to consume any beverages whilst outside.
8. An ID scanning system to the reasonable satisfaction of Police be installed and maintained at the premises. The system should be capable of sharing information about banned customers with other venues, identify the hologram of an ID and read both passports and ID cards, able to identify fake or forged ID documents to a reasonable standard. The system will be in operation at all times after 21:00 when the premises are in operation under the premises licence and will be used to record the details of all persons entering the premises including staff, members of the public, performers and their assistants. Entry to the premises will not be permitted without the production of the relevant ID document and or the person's details are already stored on the system and they are identified using a biometric identification system.

9. At all times the premises is in operation under the premises licence there will be at least one member of staff trained to a satisfactory standard able to operate the ID scan system and able to retrieve data from the system on request of the Police or other authorised officer.

10. That all staff concerned in the sale or supply of intoxicating liquor undergoes a recognised training scheme for such duties. Records of such training should be kept and made available for inspection, on request by Police or other authorised officer.

Submitted for consideration

Ian Clements

Licensing Officer Southwark Borough

 Phone: 0207 232 6756

 Mobile: 07974 836444

 E-mail: ian.clements@met.police.uk

 Mail: Licensing Office Southwark Police Station
323 Borough High Street
SE1 2ER

From: Prickett, Mark
Sent: Wednesday, January 20, 2016 1:24 PM
To: Regen, Licensing
Cc: Mills, Dorcas; Graham.S.White@met.police.uk; 'Ian Clements'; Franklin, David; Tear, Jayne
Subject: EPT rep - New premises licence for Las Congas, 516 Old Kent Road.

Dear Licensing,

The Environmental Protection Team (EPT) have reviewed the new premises licence application for Las Congas Club Limited, First Floor, 516 Old Kent Road, SE1 5BA.

The premises is described as having "2 main areas for customers, each with its own bar, dance areas and DJ station", "There is a smoking area on the first floor landing and one of the ground floor".

Licensable activities sought;

Live music (indoors), Recorded music (indoors), Supply of alcohol (both on and off premises);

Mondays & Tuesdays 09:00 – 02:00 the following day
 Wednesdays 09:00 – 04:00
 Thursdays 09:00 – 05:00
 Fridays 09:00 – 06:00
 Saturdays 11:00 – 10:00
 Sundays 11:00 – 04:00

Late night refreshment (indoors);

Mondays & Tuesdays 23:00 – 02:00 the following day
 Wednesdays 23:00 – 04:00
 Thursdays 23:00 – 05:00
 Fridays 23:00 – 06:00
 Saturdays 23:00 – 10:00
 Sundays 23:00 – 04:00

Opening hours:

Mondays & Tuesdays 09:00 – 02:30 the following day
 Wednesdays 09:00 – 04:30
 Thursdays 09:00 – 05:30
 Fridays 09:00 – 06:30
 Saturdays 11:00 – 10:30
 Sundays 11:00 – 04:30

A potential discrepancy with the the application form was noticed, whereby it states that Live Music (indoors) on Thursdays is from 19:00 - 05:00. This is in contrast to all other licensable activites for Thursday requested to be 09:00 – 05:00. Please confirm is live music is to commence from 19:00 or 09:00 on Thursdays?

Section M, part d) of the application form states the following 4 proposed conditions to address the 'prevention of public nuisance' licensing objective;

1. "Sound limiting device"
2. "Notices requesting people leave in a quiet and orderly fashion"
3. "The premises licence holder shall join and support a local Pub Watch Scheme (should there be one)"
4. "We have decieed to limit the age to persons over 21 years"

EPT stance

With regards to the conditions above;

Condition 1 simply states "Sound limiting device". This statement lacks clarity. Applicant to advise in more detail on this point.

Condition 2 relates to signage.

Conditions 3 & 4 do not relate specifically to controlling public nuisance.

The applicant is requesting extremely late hours of licensable activity, running late into every night of the week and throughout the nights on Wednesdays to Sundays.

EPT note that there are existing and currently new residential properties being built on the opposite side of the Old Kent Road to Las Congas.

EPT consider that the current operating schedule proposed to address the 'prevention of public nuisance' licensing objective (section M part d) is poor and have serious concerns regarding this current application with regards to public nuisance.

EPT therefore **make representation** against this application and await more detailed information from the applicant to fully address Section M part d) before considering this further.

Kind regards,

Mark Prickett

Principal Enforcement Officer
Environmental Protection Team
Southwark Council

Tel: 0207 525 0023

Environmental Protection Team | EH&TS | Community Safety & Enforcement
3rd floor | Hub 2 | 160 Tooley Street | London | SE1 2QH



Director of Public Health
 Lambeth and Southwark Public Health
 1st Floor, Hub 2 160 Tooley Street
 LONDON SE1 2QH

Licensing Unit
 Hub 2, Floor 3,
 160 Tooley Street,
 LONDON SE1 2QH

19 January 2016

To whom it may concern:

Re: Las Congas, First Floor, 512-516 Old Kent Road, London SE1 5BA

As Director of Public Health for Southwark (a responsible authority under the Licensing Act 2003), I wish to make representation in respect of the above.

The representation is made in respect of the following licensing objective(s):

- The prevention of crime and disorder
- Prevention of public nuisance
- Public safety

General Comments

The applicant requests both an on- and off-license to sell alcohol from the premises between the hours of 0900 and 0200 on Mondays and Tuesdays, 0900 and 0400 on Wednesdays, 0900 and 0500 on Thursdays, 0900 and 0600 on Fridays, 1100 and 1000 on Saturdays, and 1100 and 0400 on Sundays. I have concerns regarding the long hours of alcohol sales requested, and the request for an off-license.

I oppose the granting of an off-license. Las Congas functions as a nightclub and hence I am surprised an off-license license has been requested. I am concerned that patrons who have been drinking for an extended period of time will leave the club with alcoholic beverages in hand.

I also oppose the long hours of alcohol sales requested. In reference to the early start-times of 0900 and 1100 I would like to know whether food will be available at the premises. I can understand a demand to offer alcoholic beverages with lunch, but do not support the operation of a venue that only offers alcohol during the day. Day time drinking is associated with alcohol misuse and is more likely to cause public nuisance. Furthermore, increased hours of alcohol sales are



associated with an increase in alcohol-related harm. This point also supports my opposition to the very late closing times requested. I would like much earlier times of last alcohol sales. In addition to long hours of alcohol sales being associated with an increase in alcohol-related harm, research shows that those people who buy alcohol at later times during a night are more likely to drink in excess that night. I note that there is a lack of public transport in the area of Las Congas and therefore although I would like earlier times of last alcohol sales than I recommend below, I am all too aware of the public nuisance that can result from patron dispersal problems.

Recommendation

I recommend that the on-license and off-license be considered separately.

I recommend that the hours of the on-license be based on whether or not the premises offer substantial food. If substantial food is offered then I recommend the on-license be granted for the hours between 1100 and 0100 from Sunday to Wednesday, 1100 and 0200 on Thursday, and 1100 and 0500 on Friday and Saturday. If substantial food is not offered, then I recommend that the start time of alcohol sales be 1500 each day, and the end time of alcohol sales be as at the times stated in the aforementioned sentence.

I oppose the granting of an off-license to the applicant. However, if the committee were minded to grant the off-license, I would request:

- The hours of off-sales to be between 1100 and 0000 from Sunday to Thursday, and between 1100 and 0100 on Fridays and Saturdays.
- No beers, lagers, ciders or similar alcohols to be sold in cans with an Alcohol By Volume (ABV) in excess of 5% or in bottles larger than 750ml with an ABV in excess of 5%.

If you have any further questions, please do not hesitate to contact me.

Yours faithfully,

Dr Ruth Wallis BM FFPH
Director of Public Health - Lambeth and Southwark

PLEASE RETURN ANY CORRESPONDENCE TO sarah.bradbury@southwark.gov.uk



The Licensing Unit
Floor 3
160 Tooley Street
London
SE1 2QH

Metropolitan Police Service
Licensing Office
Southwark Police Station
323 Borough High Street
LONDON,
SE1 2ER

Tel: 020 -7232 6756

Our reference: MD/21/2740/16

Date: 2nd February 2016

Dear Sir/Madam

Las Congas First Floor 512-516 old kent Road SE1 5BA

Police are in receipt of an application from the above for a new premises licence under the Licensing Act 2003. On the 20th January PC Clements submitted a representation against the application. As part of this process on the 1st February 2016 I had a conciliation meeting at the premises with the applicant.

During this meeting it became apparent that they intended to sell spirits by the bottle. This is a concern to us due to previous problems associated with high levels of intoxication associated with this as the premises have no control over who consumes the alcohol once sold. Even if the bottle is purchased for a group they would have no control measures stopping one person drinking on being able to monitor customer's levels of intoxication between drinks as customers would be pouring their own.

Police would like to see the following two conditions placed on the licence,

1. That no spirits (alcohol containing more than 20% ABV) shall be sold by the bottle or half bottle.
2. That all spirits (alcohol containing more than 20% ABV) shall be sold by the measure of 25ml or 35ml at a maximum of two measures per container/glass

Submitted as additional information to our original representation.

Yours Sincerely

PC Graham White 288MD
Southwark Police Licensing Unit
Tel: 0207 232 6756

From: Prickett, Mark
Sent: Wednesday, February 03, 2016 11:15 AM
To: Mills, Dorcas
Subject: RE: EPT rep - New premises licence for Las Congas, 516 Old Kent Road.

Hi Dorcas,

To update with this application.

Myself & Graham White met with the applicants on Monday 1st Feb.

It was left to the applicant to go away and produce a thorough, detailed dispersal policy to review.

For EPT, I need to produce a list of relevant conditions regarding public nuisance and send to the applicant for approval. This has not yet been done.

Thanks,

Mark Prickett
Principal Enforcement Officer
Environmental Protection Team
Southwark Council

Tel: 0207 525 0023

Environmental Protection Team | 3rd floor | Hub 2 | 160 Tooley Street | London | SE1
2QH

Date 3/2/16

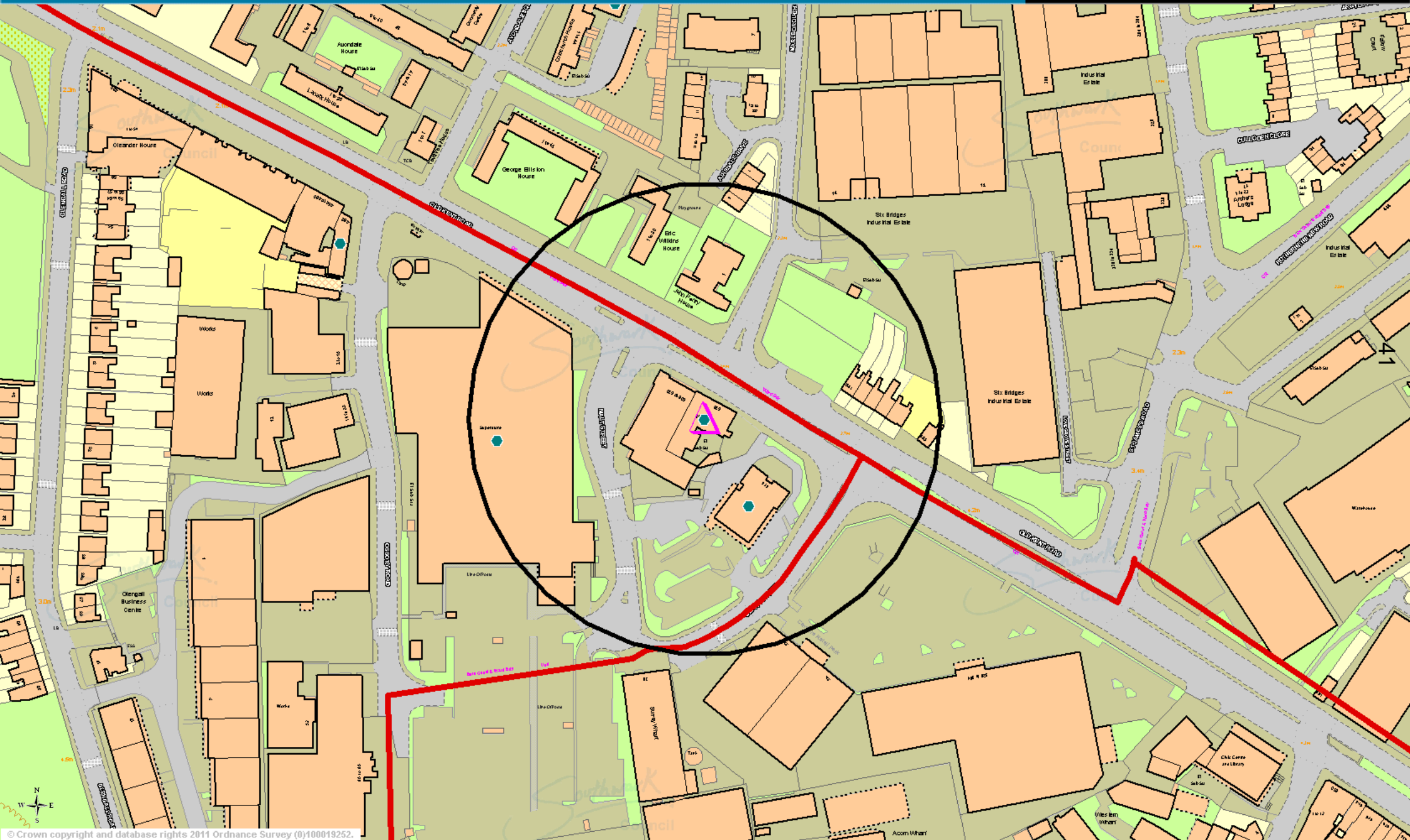

This page left intentionally blank.

LICENSING SUB-COMMITTEE DISTRIBUTION LIST (OPEN) MUNICIPAL YEAR 2015-16

NOTE: Original held by Constitutional Team; all amendments/queries to Andrew Weir - Tel: 020 7525 7222

Name	No of copies	Name	No of copies
Members		Officers	
Councillor Renata Hamvas (Chair)	1	Debra Allday, Legal team	1
Councillor Jon Hartley	By Email	Dorcas Mills, Licensing team	1
Councillor Eliza Mann	1	Mark Prickett, Environmental Protection Team	1
Reserve		Sarah Bradbury, Public health	1
Councillor Adele Morris	By Email	Andrew Weir (spares)	5
		Total printed copies: 11	
		Dated: 9 February 2016	