

COVID-19 Post-Lockdown Highway Schemes

Appendix	27
Location	Walworth Streetspace – Penton Place at the junction with Kennington Park Road
Proposal	Introduce a point closure on Penton Place at the junction of Kennington Park Road
Ward(s) affected	Newington

Background / Request

- Walworth Streetspace programme aims to enable walking and cycling to prevent an increase in traffic levels which could be caused by the COVID-19 lock down restrictions
- Proposed as a wider set of measures to prevent through-traffic in the area
- Repurpose the streets for the local community

Location

- Penton Place, Newington
- Penton Place is in West Walworth (Zone E) controlled parking zone (CPZ), implemented in 1999.
- Zone E CPZ is in operation 8.30am – 6.30pm Monday – Friday.
- There are currently pay and display bays, disabled bays and permit holders only bays along Penton Place.

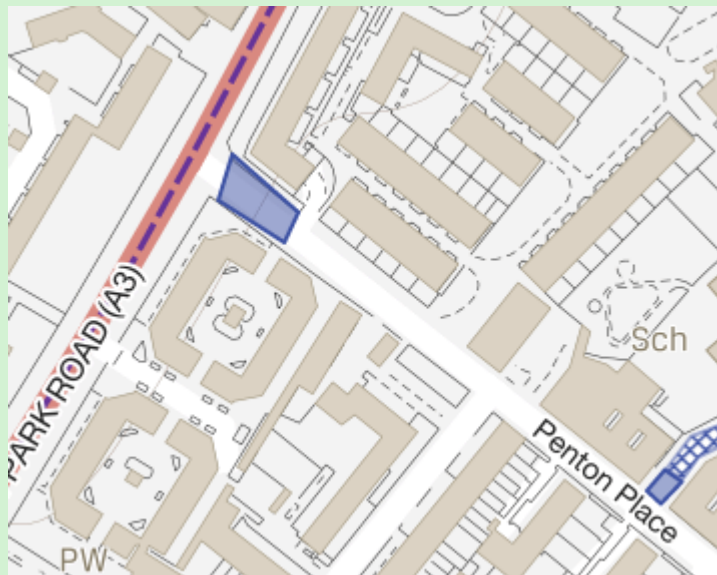

Feedback from Stakeholders

Comments

Investigation and conclusions

- Officers visited site on 1st July 2020 and undertook community engagement regarding the Walworth streetspace experimental measures. Concerns were raised regarding the junction of Penton Place/Kennington Park Road becoming one of the main entry and exit points for vehicles into the West Walworth area.
- Introducing a point closure on Penton Place at the junction of Kennington Park Road needs to be considered holistically with reviewed point closure locations in West Walworth area North of Manor Place.
- A meeting was also held with stakeholders and Cllrs on the 10th July to discuss proposals and new location of closure on Penton Place.
- A meeting was held with emergency services on 16th July to discuss relocation of closure and impact on Manor Place Police Station.
- A meeting was held with Transport for London on 16th July to discuss impact on TLRN network.

Recommendation

It is recommended that:

- a point closure is installed on Penton Place at the Kennington Park Road junction.
- Resident bays immediately South-East of point closure to be removed to provide a safe turning head.
- Cyclists will be exempt from closure.
- This will require the point closure on Manor Place/Penton Place to be revoked.
- In addition to this the proposed re-instating of two-way working on Penton Place, South of Manor Place is to be revoked.

This proposal is to be implemented under an Experimental Traffic Management Order (ETMO). An ETMO is the legal mechanism the council as traffic authority uses to control aspects of the way that the highway is used. They provide the legal backing to signs and road markings used on the highway and allow them to be enforceable.

A detailed design drawing is included in this document.

Next steps

Should this non-strategic Traffic and Highway improvement proposal be approved the council will make arrangements to install the restrictions (road marking and signage).

Audit trail

Reference	27
Report author	RG
Ward members notified	Yes

NOT FOR CONSTRUCTION

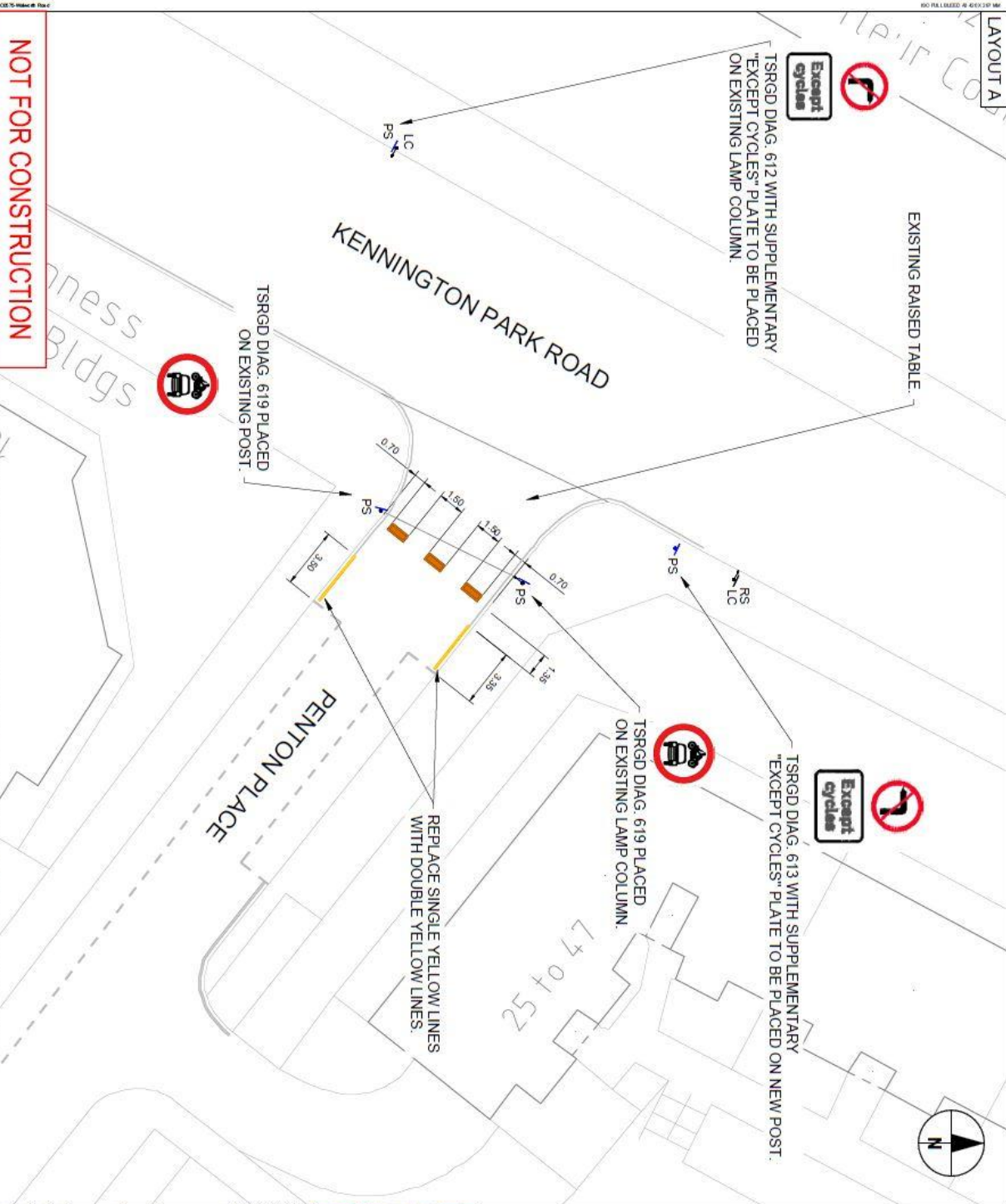

LEGEND

- Existing road markings
- Proposed double yellow lines
- Existing lamp column
- Existing sign on existing lamp column
- Proposed sign and post
- Proposed sign on existing post
- Proposed plate (120050050 mm)

- NOTES**
- All construction is to meet urban objectives and standards.
 - The information shown on this drawing is based on an OCS been used in conjunction with the relevant planning consent.
 - Refer to the relevant planning consent and the L3 Sustainable Resilience Design Guidance (SRDG) and all relevant contract clauses for further information.
 - Refer to the relevant planning consent and Chapter 8 of the Traffic Signs Manual and Safety at Street Works and Road Works for further information.
 - Refer to the relevant planning consent for excavation and other utility notices.
 - Contractor to maintain access to all properties and to ensure that all pedestrians, cyclists, horse riders, etc. are able to use alternative access arrangements with appropriate signage.
 - Contractor to ensure that all works are completed within the agreed timescale.
 - Contractor to ensure that all works are completed within the agreed timescale.
 - Contractor to ensure that all works are completed within the agreed timescale.
 - Apply temporary safety paint to cover over 20mph zone signage.



NO.	DESCRIPTION	DATE	BY	CHECKED BY
1	ISSUED FOR TENDER	15 JULY 2020
2	REVISED
3	REVISED
4	REVISED
5	REVISED
6	REVISED
7	REVISED
8	REVISED
9	REVISED
10	REVISED

Shipping Southwark's Highways

 148 TOLPUY STREET LONDON SE16 4JA

PROJECT
 WALWORTH ROAD
 LEN TEMPORARY MEASURES
 GENERAL ARRANGEMENT
 SHEET 1 OF 4

CONTRACT NO.	60409262-02875	NUMBER	028
SCALE	1:200 @ A3	DATE	15 JULY 2020
DESIGNER	DEBOLISSON	PROJECT NO.	60409262-02875-01
DATE	15 JULY 2020	PROJECT NAME	WALWORTH ROAD